

Pursuant to a warrant from  
 John Thomas Esq. dated 15<sup>th</sup> June  
 1779. I have measured & laid out unto John  
 Youngs a tract of five hundred acres of  
 land in Washington District Greenville  
 County on both sides of Fall Creek water  
 side of the Middle fork of Saluda river  
 bounded S.E. by John Woods land  
 N.W. by William & John Youngs land N.E. by William Youngs land  
 W. by William & John Youngs land, and hath such shape form  
 and marks as the above Plat represents, recorded 18<sup>th</sup> Sept 1779.  
 Recorded 20<sup>th</sup> Sept 1779.

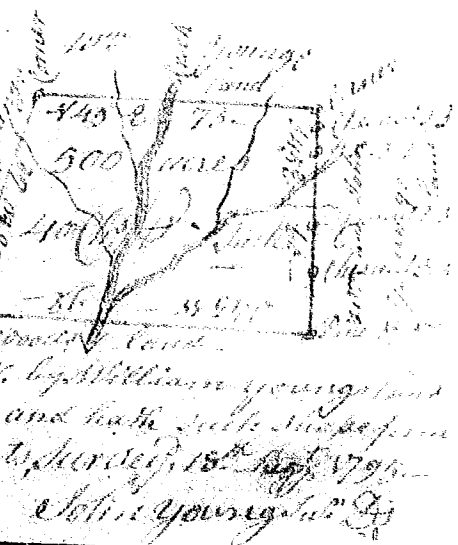

State of South Carolina Pursuant to a warrant from  
 John Thomas Esq. Commissioner of Locations N side Saluda  
 I have measured and laid out unto Robert Gault a  
 tract of one hundred & Twenty acres of land, bounded  
 S.E. by James McWhorters land, & by David Puchetts land  
 N.W. by John Foster land, and hath such shape form &  
 marks as the annexed Plat represents -  
 Surveyed by me 25<sup>th</sup> febr 1796.

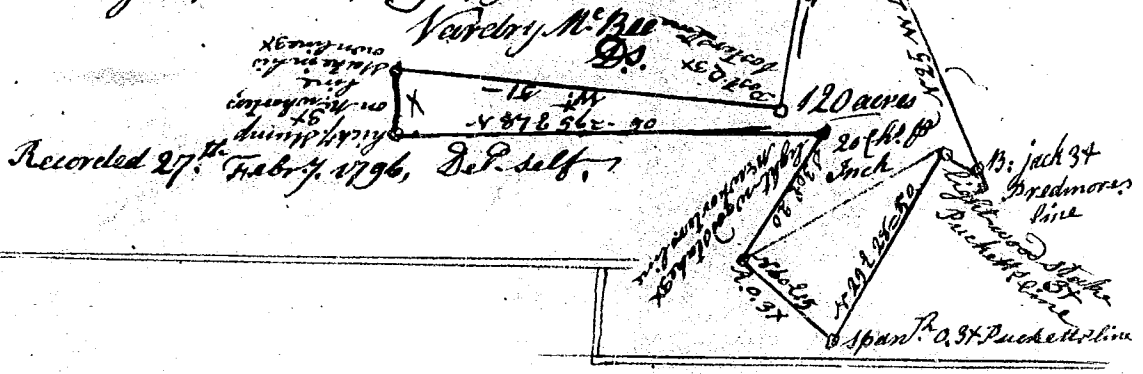

Recorded 27<sup>th</sup> febr 1796, J. P. self.