

South Carolina / Pursuant to
 a warrant from John Thomas
 Com^r of Loc^s of Saluda have
 admeasured and laid out unto
 John Stubs a tract of one hundred
 and sixty two acres of land
 on the branches of people's
 Creek, bounded S by William
 Stubs's land, W by Macajah Taylors land, S^W by John Hoke's land, E by
 John Leck's land, and hath such shape and marks as the above
 plat represents - Survey 20 July 1798. Verdij. H. Rice Esq.
 Recorded 20th Nov^r 1798

458

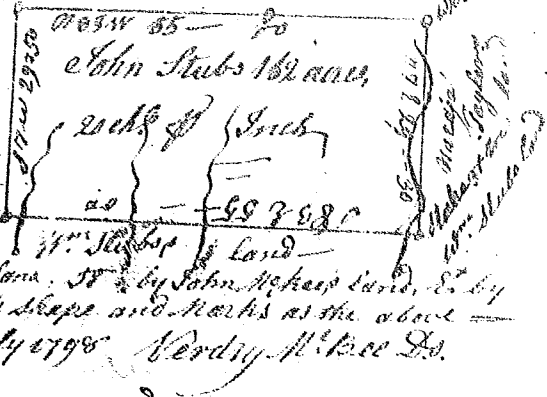

State of S^c Carolina / Pursuant to a warrant
 from John Thomas, Com^r of Loc^s of Saluda
 dated 13th Nov^r 1798, I have admeasured
 and laid out unto Charles Dean
 a tract of one hundred &
 sixty seven acres of land in
 Greenville County, bounded
 by Lines Nursing's
 land, Thomas David's
 Lewis & Benj^t Kilgore's
 lands, W^W by N. Sant
 Kelly & William Boone's
 lands & by Ennore's side, and
 hath such shape and marks
 as the above plat represents.
 Recorded 21st Nov^r 1798, / Survey 15th Nov^r 1798 J. H. Kilgore

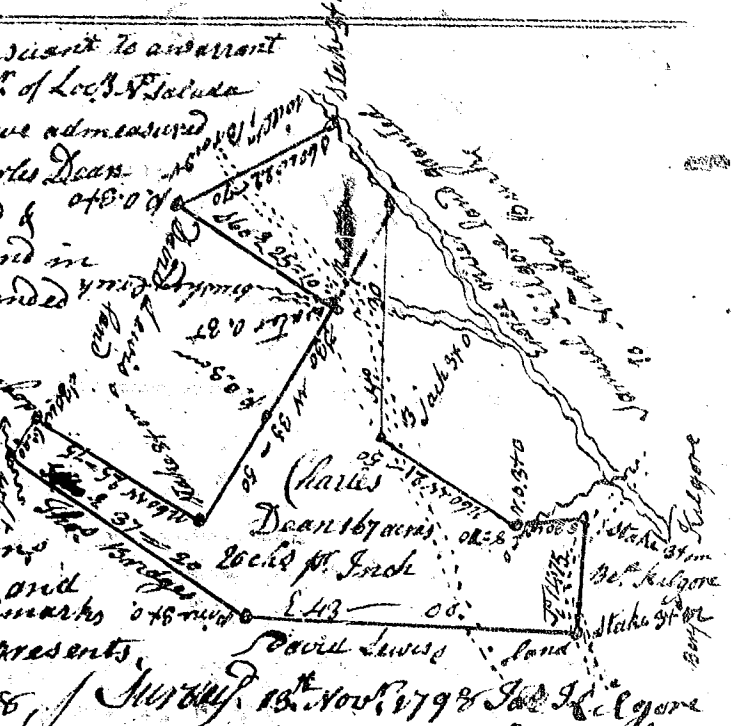

S^c Carolina / Pursuant to a warrant
 from John Thomas, Com^r of Loc^s dated
 23rd April 1798, I have admeasured and laid
 out unto Thomas Shevener a tract
 of Twenty six acres of land in
 Greenville County on the S^W side of Needy River on both
 sides of a small branch of said River, bounded by Lines
 Nursing & by William Sweet's land S^W by Benjamin
 Griffiths land S^W by John Goodwin's land, and hath
 such shape and marks as the above plat represents,
 Survey 24th April 1798. James Kilgore Esq.
 Recorded 21st Nov^r 1798

