

S Carolina

Pursuant to a warrant from John Thomas Esq. Comr. of Locations N^o Saluda River Dated the 2^d day of August 1790. I have admeasured and laid out unto ~~James Campbell~~ a Tract of ~~75~~ ⁷⁵ Acres of Land Situate in Newberry County Ninety Six District on Peebles Creek waters of Enoree River Bounded by lines Running N^o East on Land surveyed for John Garrett by lines Running N^o E & N^o W by William Seager by lines Running N^o W & N^o E on Land unknown by a line Running S^o E by John Lindsay by lines Running N^o E & N^o W on James Shivers by lines Running S^o E S^o E S^o W S^o E N^o E & S^o E on John Simons by a line Running S^o W on Isaac Evans Land and hath such for in and marks as the above Plat Represents. Surveyed the 3^d day of August 1790

Abel Pearson D. S.

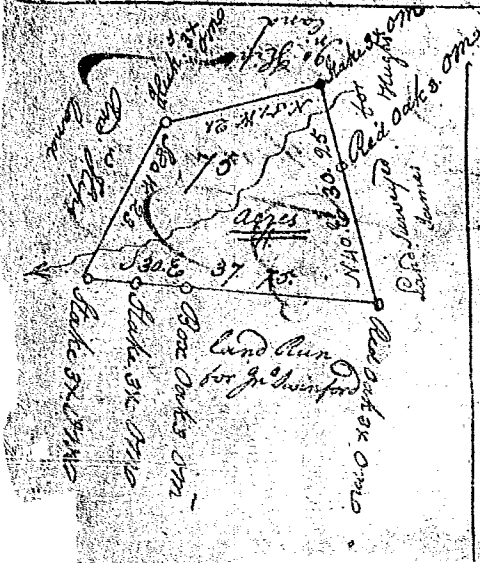

S Carolina Pursuant to a warrant from John Thomas Esq. Comr. of Locations N^o Saluda River Dated the 22^d day of Sept^r 1788. I have admeasured and laid out unto James Campbell a Tract of Seventy five acres of Land Situate in Newberry County Ninety Six District below the Indian Boundary on a small branch of Duncan Creek a Draft of Enoree River Bounded by a line Running N^o E on Land surveyed for James Houghs by a line Running N^o W by Land Run for And^o Slip by a line Running S^o W by John Lips & by a line Running S^o E by John Swinfords Land and hath such for in and marks as the above Plat Represents

Surveyed the 24th day of Sept^r 1788

Abel Pearson D. S.