

St. of S. Carolina

Pursuant to a warrant from John Thomas Egg
 Com^r of Locations N^o Saluda River dated the 4th March
 1792 I have admeasured and laid out unto Walter Roberts a
 tract of thirty eight acres of land situate in Union County
 Ninety six district on the N^o Side of Enoree River Bounded
 N^oE by W^m Woolbanks land S^oE by W^m Rays land S^oW by
 Walter Roberts land N^oW by James Jacksons land and
 hath such shape & marks as the above plat Represents.
 Surveyed the 7th Day of March 1792

Jeremiah Cooper D^s

State of S. Carolina

Pursuant to a warrant
 from John Thomas Egg Com^r
 of Locations N^o Saluda, dated the
 4th March 1792 I have admeasured
 and laid out unto Walter Roberts
 a tract of fifteen acres of land
 situate in Union County Ninety
 six district on the N^o Side of
 Enoree River on a small Branch of Johns Creek. Bounded
 S^oW by land laid out N^oW & N^o on John Taylors Land
 S^oE on James Jacksons Land and hath such shape & marks
 as the above plat Represents.

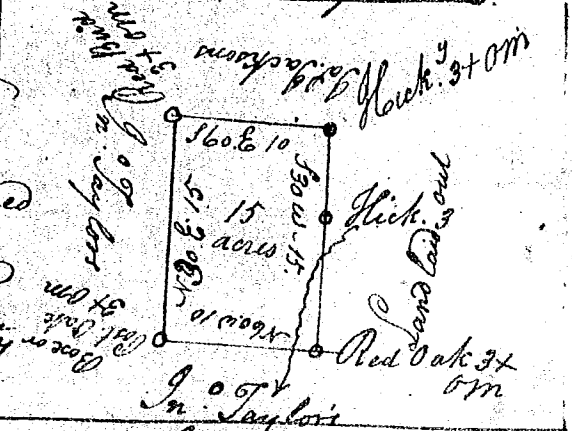

Surveyed the 10th March 1792 Jeremiah Cooper D^s