

Laid down by a Scale of 20 Chains to an Inch

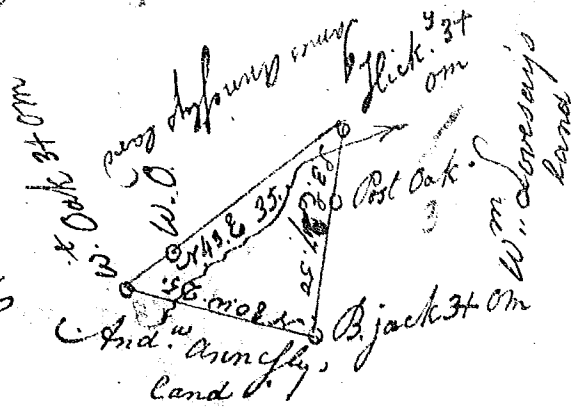

S. Carolina

Pursuant to a Warrant from John Thomas Esq^r Com^r of Locations No. Saluda dated the 17th day of April 1792 I have admeasured and laid out unto James Anesly a tract of thirty acres of Land on a small branch of Duncan's Creek bounded Eastward by William Lovesay's Land N.W. on Andrew Anesly's Land & N.E. on James Anesly's Land and both such Shape & Marks as the above plat Represents Surveyed the 12th April 1792

Robert Hanna D.S.



S. Carolina Pursuant to a warrant from John Thomas Esq^r Com^r of Loc^s No. Saluda I have admeasured and laid out unto William Wright a tract of one hundred & forty six acres of land on the S. Side Reddy River Bounded by a line running N.E. 20 on land surveyed for Daniel M. Lean all other sides by old surveys and both such form and Marks as the above plat Represents Surveyed the 18th November 1791

Adam Grain Jones, D.S.