

S. Carolina
 Pursuant to a warrant from John Thomas Esq.
 Comr. of Locations N. Saluda, Dated this day - have
 admeasured and laid out unto James Cheek a tract of One
 hundred & twenty six acres of Land on a Small Branch of the
 Beaver Dam Creek, of Enoree River in Laurens County
 Bounded West on Jesse Higgins Land, S. on Dr. Ross' Land,
 East, N.E. & S.E. on Lewis Saxon and Rahls Land N.W. on Widow
 Cheeks & S.W. on Stephens Land and hath such Shape &
 Marks as the above plat Represents.
 Surveyed the 19th day of Sept. 1792
 Robert Hanna
 Dep. Surv.

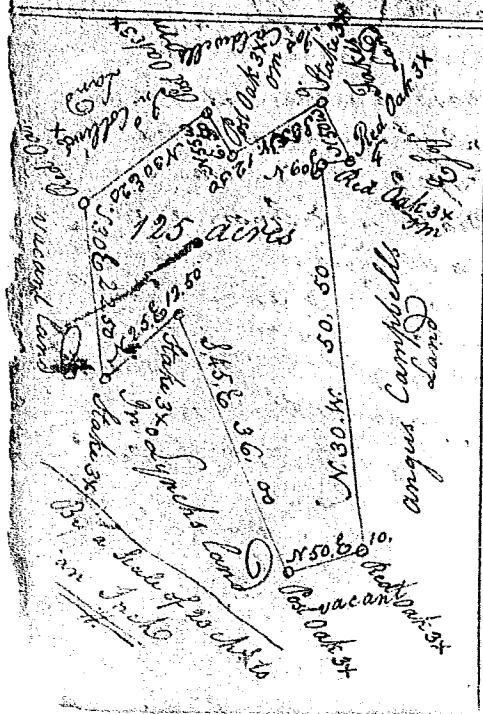

S. Carolina
 Pursuant to a warrant from
 John Thomas Esq. Comr. of Locations N. Saluda
 dated this day, I have admeasured and laid out
 unto Boardvine Waters a tract of One hundred
 and twenty five acres of Land on a Branch of
 warriors Creek called Lynch's Creek in Laurens
 County, Bounded S.E. & N.E. by John Lynch's &
 vacant Land N.W. by Angus Campbell's and Esq.
 Tates Land, & S.W. by J. Caldwell's and John
 Collins Land and hath such Shape and
 Marks as the above plat Represents.
 Surveyed the 20th day of Sept. 1792
 Robert Hanna
 D.S.