

State of S. Carolina

Pursuant to a warrant from John Thomas Esq. Com. of Locations N. Saluda River. Bearing date the 20th March 1792. I have admeasured and laid out unto Hudson Barry a Tract of three hundred and seventy five acres of Land lying & situate on the Branches of Beaver Dam and Derbins Creek in Laurens County Running S.E. with M. Cluckins Land N.E. & S.E. with Travers Land N.E. with John Cobiers & Simpsons Land, N.W. with Winns and S.W. & N.W. with Ratcliff's land, all other Sides with vacant Land and hath such Shape and marks as the above plat Represents.

Surveyed the 26th July 1792. James Wofford Esq.

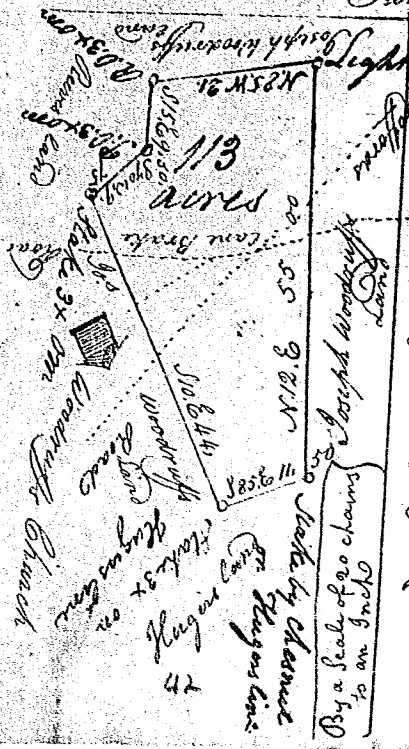

State of S. Carolina

Pursuant to a warrant from John Thomas Esq. Com. of Locations N. Saluda. Dated this day, I have admeasured and laid out unto Joseph Woodruff a Tract of one hundred and fifteen acres of Land on the dividing Ridge between Enorce and Tyger Rivers in Spartanburg County. — Bounded N.E. N.W. & S.E. on said Woodruff's Land S.W. and S.W. on Reeves and Buggers Land, Having such Shape and marks as the above plat Represents

Surveyed the 16th day of July 1792. Robert Hoopes Esq.