

State of S. Carolina

Pursuant to a warrant from John Thomas Esq^r Com^r of Locations N. Saluda River dated the 10th day of ^{March} 1772 I have admeasured and laid out unto Lewis Saxson a tract of two Hundred acres of Land in Laurens County on the South fork of Rayburns Creek Bounded to the N. W. on the Widows Reeds land East on lands unknown S. & S. E. on Isaac Hugens land, all other sides on vacant land, and hath such Shape and marks as the above plat Represents Surveyed the 6th day of May 1772

Thomas Dorson Jr.

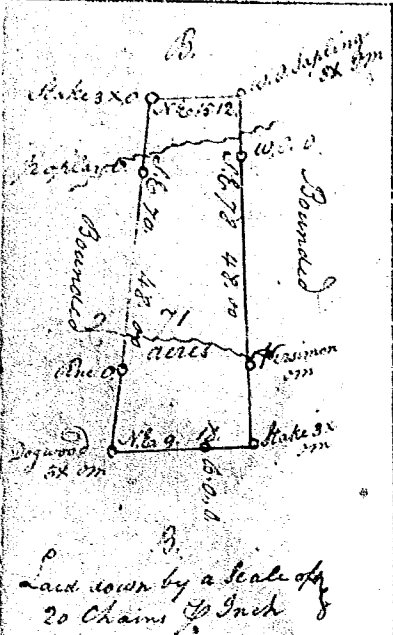

S. Carolina

Pursuant to a warrant from John Thomas Esq^r Com^r of Locations N. Saluda River dated the 28th day of February 1772. I have admeasured and laid out unto Thomas Shirley a Tract of Land Containing Seventy One acres Situate lying & being in Laurens County on Branches of Saluda River Bounding on all sides by old Surveys and hath such Shape form and marks as the above plat Represents Surveyed the 28th day of February 1772

A. C. Jones Jr.