

Laid down by a stake of
20 Chads to an inch

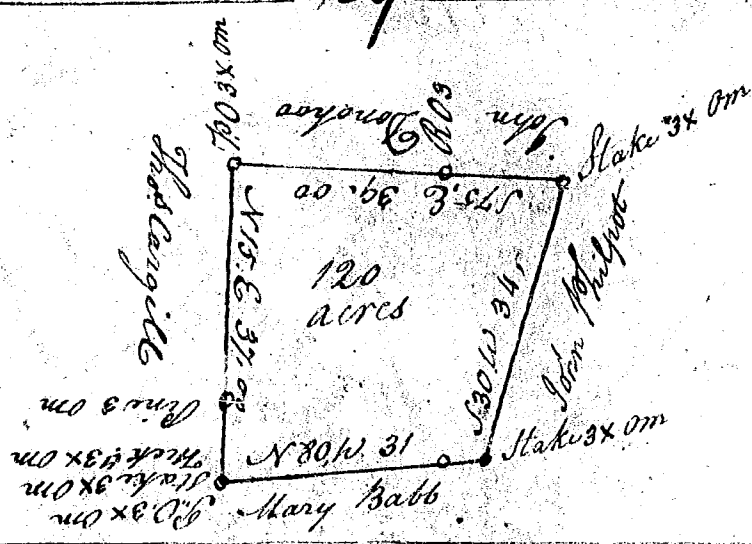

Laurens County Pursuant to a warrant from John Thomas Esq^r Com^r of Locations N. Saluda River dated the 2^d day of Nov. 1792. I have admeasured & laid out unto John Philpot a tract of One hundred & twenty acres of land on a branch of Beaver Dam the waters of Little River bounding to the S^o on John Donohoe E on Thomas Cargill N & W on Mary Babb & John Philpot and hath such shape & marks as the above plat Represents Surveyed the 3^d day of Nov. 1792
John Rodgers D^s

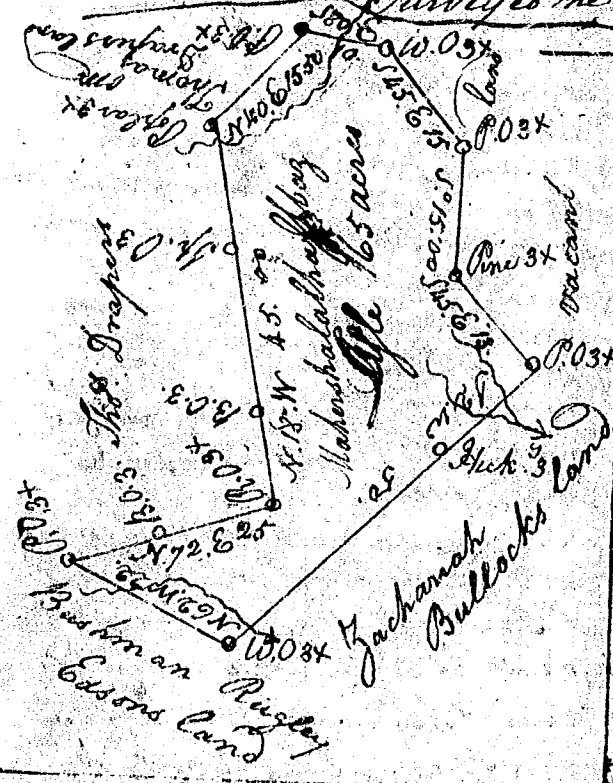

State of S. Carolina
Pinckney District
Pursuant to a warrant from John Thomas Esq^r Com^r of Loc^t dated the 23^d Sept. 1792. I have admeasured and laid out unto Mahershalathashbag Lyle a tract of One hundred & Sixty five acres of land Between Broad & Saluda Rivers near the South Side of Peeled River on a Small Branch of Mill Creek and Jumping Run in Union County Bounded to the S^o & W by Thomas Drapers Land S E & E^o by Zachariah Bullocks Land and Bushman Rugley

Edsons Land, all other sides on vacant land and hath such shape & marks as the above plat Represents Surveyed the 12th Oct. 1792.
Andrew Thomson D^s