

S<sup>c</sup> Carolina

Pursuant to a Warrant from John Thomas  
 Esq. Com. of Locations. N. Saluda dated Feb. 19<sup>th</sup> 1793  
 I have admeasured and laid out unto James Lindsay  
 a Tract of two hundred & eighty six acres of land  
 on a branch of Indian Creek called Georges Branch  
 Bounded by a line Running S 18. E by John Lindseys Case  
 S. E. by S. John Lindseys Land N. E. by One Rutledges Land  
 N. W. by In. John Johnsons Land and S. W. by Lands Laid  
 out to W. M. Jay and hath such Shape & Markes as the  
 above plat Represents  
 Surveyed the 16<sup>th</sup> March 1793  
 A. Pearson Ds

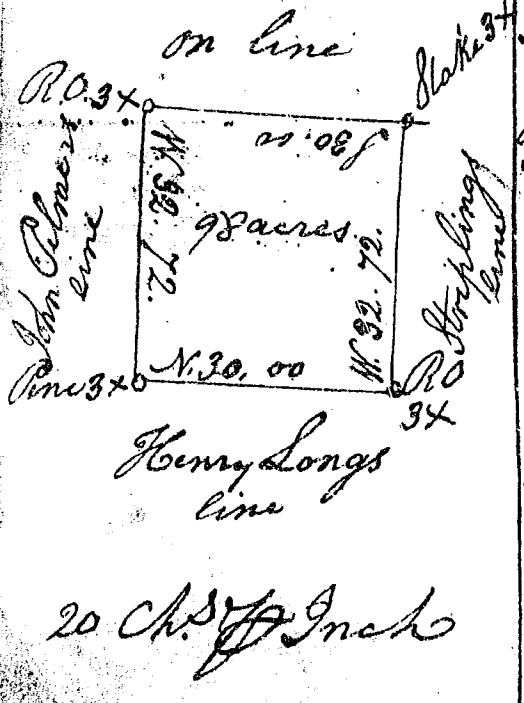

S<sup>c</sup> Carolina  
 Pursuant to a warrant  
 from John Thomas Com. of Locations  
 I have admeasured & laid out unto Archelus  
 Fore a Tract of Ninety Eight acres  
 of Land in Pinckney district on the  
 S. Side of Broad River in the fork  
 of Browns Creek and hath such  
 Shape and Markes as the above  
 plat Represents  
 Surveyed the 15<sup>th</sup> July 1793  
 Chas. Sims Ds