

~ 1764

S. Carolina

Pursuant to a warrant from John Thomas Com. of Locations No. Saluda dated this day I have admeasured and laid out unto Samuel Bishop and Hugh Monford a tract of two hundred and forty acres of land on the Branches of Enoree River in Laurens County. Bounded N. E. on Robert Rosebrough's & Andrew Owens land S.W. on Tho. Fla. Ellens and Sam. Bishops land S.E. on land laid out to Willson and the said Hugh Monford and hath such Shape and Marks as the above plat Represents.

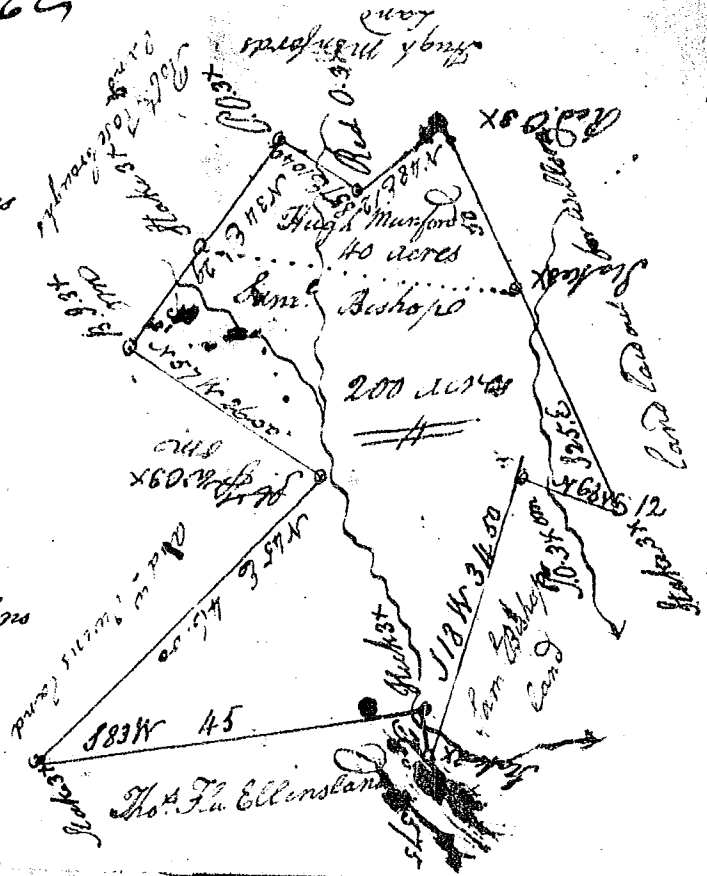

Surveyed the 14th day of January 1794

Robert Hannan Lt.

S. Carolina

Pursuant to a warrant from John Thomas Esq. Com. of Locations No. Saluda dated the 19th day of Jan. 1794 I have admeasured and laid out unto John M. Gee a tract of One hundred and ten acres of land on the Branches of Walnut Creek of Ruddy River Bounding N. on lands laid out to John Briant Dec. E. on Patrick Cunningham & John Hustison S. on Nathan Gails and James Braden W. on land claimed by W. M. Braden and hath such Shape & marks as the above plat Represents.

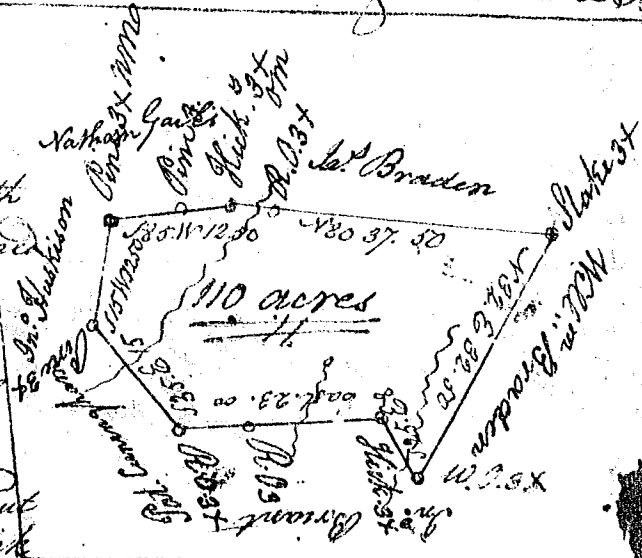

Surveyed the 14th Jan. 1794

John Rodgers Lt.