

215
 S^c Carolina Pursuant to a warrant
 From John Thomas Esq. Com. Locations No. of Saluda
 dated the 18th Jan^y 1798. I have admeasured and
 laid out unto Thomas Howland a tract of 500
 Acres of land Union County, waters of Nees
 creek of Broad river, bounded as f^oll^o plat
 Survey^d the 2^d Jan^y 1798 Tho. Porter Esq
 Recorded 4th

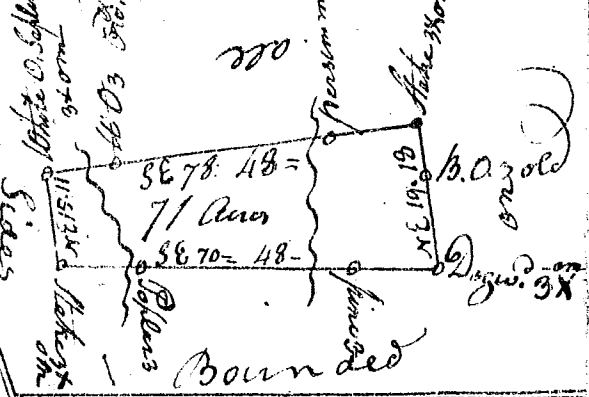

This tract of Seventy one acres
 for John Waldrop in Laurens
 County on a branch of Saluda River
 was Surveyed the 30th March 1794
 Recorded the 23rd Jan^y 1795



Surveyed for John Speake a tract
 of 155 Acres of land in the
 County of Newberry on the ridge
 between Indian & Pattersons
 creeks on both sides the
 Great road leading down to
 Charleston from Milledgeville
 &c - Bounded as f^oll^o plat
 Survey^d the 7 Jan^y 1795 Robt Hamme Esq
 Recorded 5th March 1795

By a Warrant dated the 23rd Feb^r 1795 I have laid out
 to John Speake a tract of 88 acres in Newberry
 County on a branch of Pattersons Creek
 Bounded as f^oll^o plat - Survey^d 25 Feb^r
 1795 by Abel Pearson Esq
 Recorded 5th March 1795

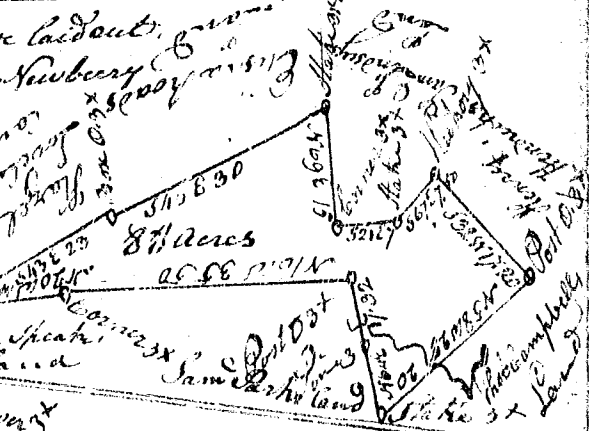

This tract of 100 Acres on a
 branch of Pattersons creek is bounded as
 f^oll^o plat was Survey^d the 10th Jan^y
 1796 by James Wofford Esq