

South Carolina Pursuant to a warrant from John Thomas Comr. of Loc. 2^d dated 7th Nov^r 1801 I have surveyed for Larkin Cardin a tract of 244 acres & 20 ch. of Spruce on both sides of S. Pacolet river about a mile above the Fork in Spartan District. Bounded N. by the river & M. Bowles land E. by Bennetts & Speares lands, S. by the river & Bennetts land W. by Clarke & Youngs land, and hath such shape & marks as the above Plat represents, Survey 14th Nov^r 1801 Jas. Smith D.S. Recorded 11th Jan^y 1802

South Carolina Pursuant to a warrant from John Thomas Comr. of Loc. 2^d dated 7th Nov^r 1801 I have surveyed for Larkin Cardin a tract of one hundred & fifty two acres of land on the head branches of Pealy branch & some other branches of Lawson's fork on both sides of the rather good Road about one mile above the boiling Spring Meeting house bounded N. E. W. & S. W. by Cardin's land S. E. by vacant land, and hath such shape and marks as the above Plat represents, Survey 14th Nov^r 1801 — Recorded 11th Jan^y 1802 — James Smith D.S.

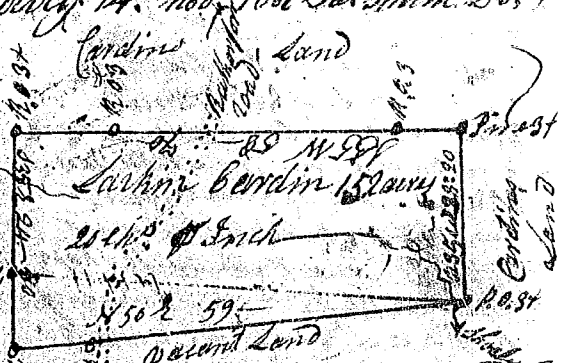

South Carolina Pursuant to a warrant from John Thomas Comr. of Loc. 2^d dated 2^d Jan^y 1802, I have surveyed for George Hatfield 220 acres of land in Spartanburg District on Pacolet river on the side bounded N. by Gray's land E. by Goore's land S. by Hatfield's land, and hath such shape, marks, buttings & boundaries as the above Plat represents, Survey 8th Jan^y 1802 — Recorded 14th Jan^y 1802 — Jas. Smith D.S.

