

(237)  
 South Carolina Pursuant to a warrant from  
 John Thomas Com' of Loc' A side Saluda dated  
 18<sup>th</sup> Jan'y 1802. I have admeasured and laid out  
 unto George Sherry a tract of thirty acres  
 of land in Union District on waters of  
 Bogans Creek a branch of Cain Creek of Tyger River  
 bounded S.E. by Sims Browns land, N.E. by Meshaw  
 Lovellins land S.W. by George Allford Land, and  
 hath such shape & marks as the above Plat represents  
 = this done the 20<sup>th</sup> Jan'y 1802. — John P. Barber Es.  
 Recorded 21<sup>st</sup> March 1802

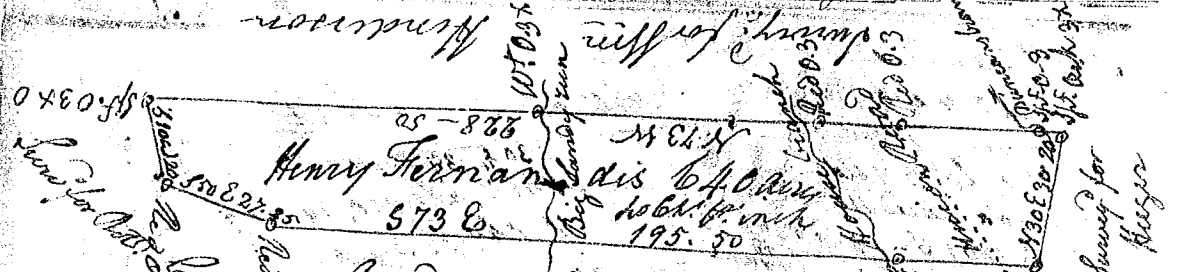

South Carolina Pursuant to a warrant  
 from John Thomas Com' of Loc' A side Saluda dated  
 15<sup>th</sup> March 1802 I have admeasured and  
 laid out unto Jonathan Wallis a tract  
 of sixty one acres of land in Union  
 District on both sides of mountain branch  
 waters of the Cr. of the Dis. of Union  
 bounded by lines running  
 N.W. by Michael Wallis land S.W. by  
 William Bouvens land S.E. by Deuces land and  
 Nordica Moores land N.E. by unknown land  
 shape, marks, & lying as the above Plat represents  
 = this done the 20<sup>th</sup> March 1802 —  
 Recorded 24<sup>th</sup> March 1802 — John Kilgore Es.

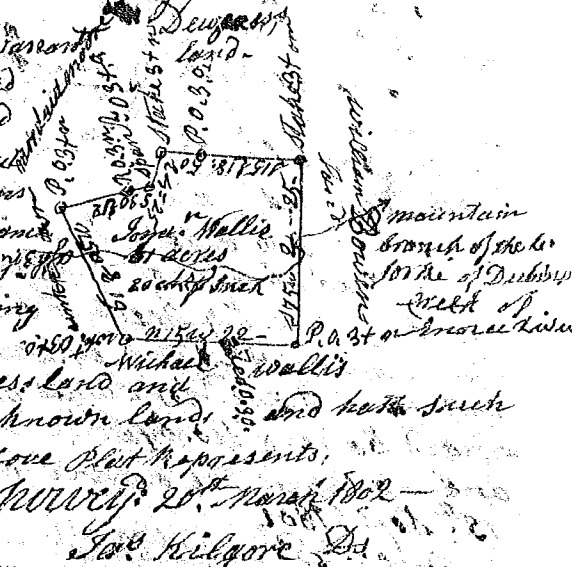

South Carolina Pursuant to a warrant from John  
 Thomas Com' of Loc' A side Saluda dated the 19<sup>th</sup> February 1802  
 I have admeasured & laid out unto Henry Ferdinand  
 a tract of land containing five hundred & forty acres  
 situated in the Dis. of Union on both sides of Cain  
 river of the Cr. of the Dis. of Union bounded by a line running  
 land surveyed for Henry V.W. Henderson a Wife by John  
 Ademan & John Henderson of both such form & marks as the  
 above Plat represents = this done the 5<sup>th</sup> March 1802  
 Recorded the 25<sup>th</sup> March 1802 — Rushy Thomson Es.