

(241) Pursuant to a warrant from John Thomas Com^r of loc^t N Side Saluda dated 29th March 1802. I have administered & laid out unto John James a tract of forty seven acres of land in Union District on branches of Mill Creek, waters of Pacolot River, bounded by a line turning S.E. by land survey for Arthur Cunningham N.E. & S.E. by John Hails & John Gilson's Town N.W. & S.W. by land survey for Handel James, & land said to be Ridge Grinke, and hath such form & marks as the above Plat represents. Recorded 3rd April 1802 3/ Survey 31st March 1802, by Rich^d Thomson D.

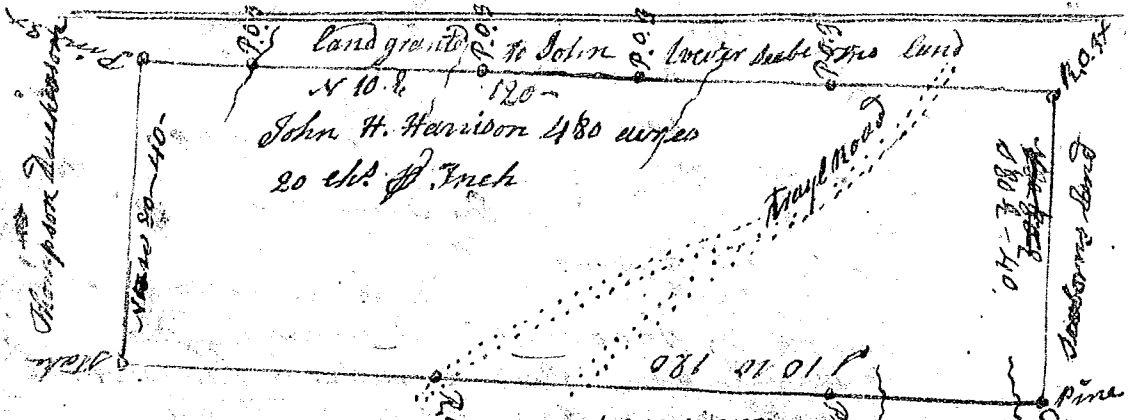
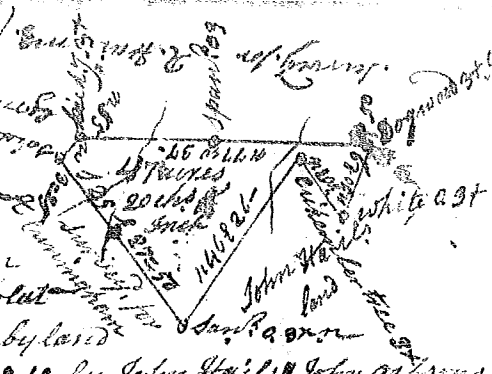

Pursuant to a warrant from John Thomas Com^r of loc^t N Side Saluda I have laid out unto John H. Harrison a tract of four hundred & eighty acres of land in Greenville District on branches of the golden grove creek & Meddy fork of Meddy River, leaving such shape & marks, buttings as the above Plat represents, Recorded 16th May 1802 - Survey 8th March 1802, John H. Harrison D.

S^c Carolina N. Dist. Pursuant to a warrant from John Thomas Com^r of loc^t N Saluda, dated 20 Aug^t 1802. I have administered & laid out unto Michael Hilber a tract of seventeen acres of land, on a branch S. side Cannon Creek of Broad River, S.E. & W. on Adam Largourds land, and hath such form and marks as the above Plat represents. Survey 14th Sept 1802. H. Cates D.

Recorded 7th Sept 1802

