

54

South Carolina,
Pursuant to a
Warrant from Wm.
Davis Thomas, Com.
Locations for Green
ville district, dated
the 7th Decr 1807.
I have admeasured
Laid out unto Dan.
Wilbanks a tract of
Land Containing
Fifty two acres.

Situate in said District on a
branch of Thompsons Beaverdam creek
waters of Middle Sugar river. Bounded by a line running
N.E. by land Survey'd for Elisha Thompson N. by the
ancient boundary line, N.W. by land Survey'd for Thomas
& Cochran S.E. by land Survey'd for John Clement
with such Form and Marks as the above plat represents
Survey'd the 21st Decr 1807 (Dan. Wilbanks D.D.)
Recorded 7th Aug^r 1809

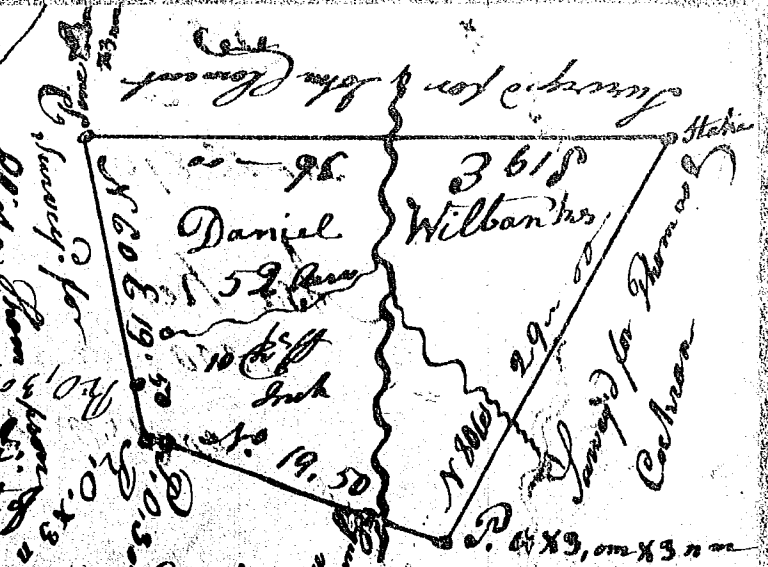

[Faint, mostly illegible handwritten text, likely bleed-through from the reverse side of the page.]