

Scale 20 to an  
Inch

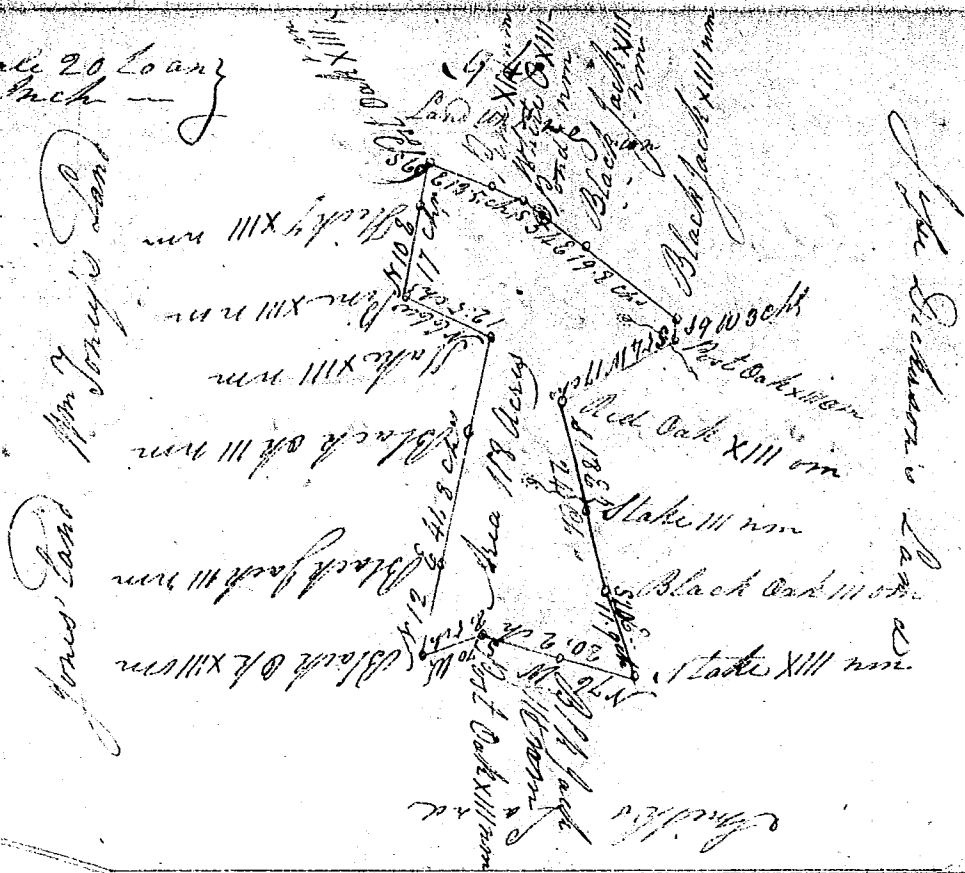

South Carolina  
Greenwich District } Pursuant to a Special warrant from  
John Young, Comm<sup>r</sup> Locations bearing  
date the 3<sup>rd</sup> Jan<sup>y</sup> 1825. I have measured & laid out  
unto Hanson Cobb a tract of land containing one  
hundred and sixteen acres, situate in the above  
mentioned District, on branch ofuddy fork of Ruddy  
River. Bounded by lines running SW and SE on  
Jesse Dickerson's land, NE & NW on Smith's  
land NE on Jones' land, NW & SE on John Young's land  
and on all other sides by land unknown. Which  
land was formerly run for Jesse Dickerson on the  
5<sup>th</sup> day of March 1824 and stands Elapsable and  
hath such form, marks, Bittings, & Boundings  
as the above Plat represents. Surveyed the 4<sup>th</sup> day  
of Feb<sup>r</sup>y 1825  
G. Seaborn D<sup>r</sup>

Recorded the 10<sup>th</sup> day of Feb<sup>r</sup>y 1825 by  
John Young, C<sup>l</sup> Sec<sup>y</sup>