

172,

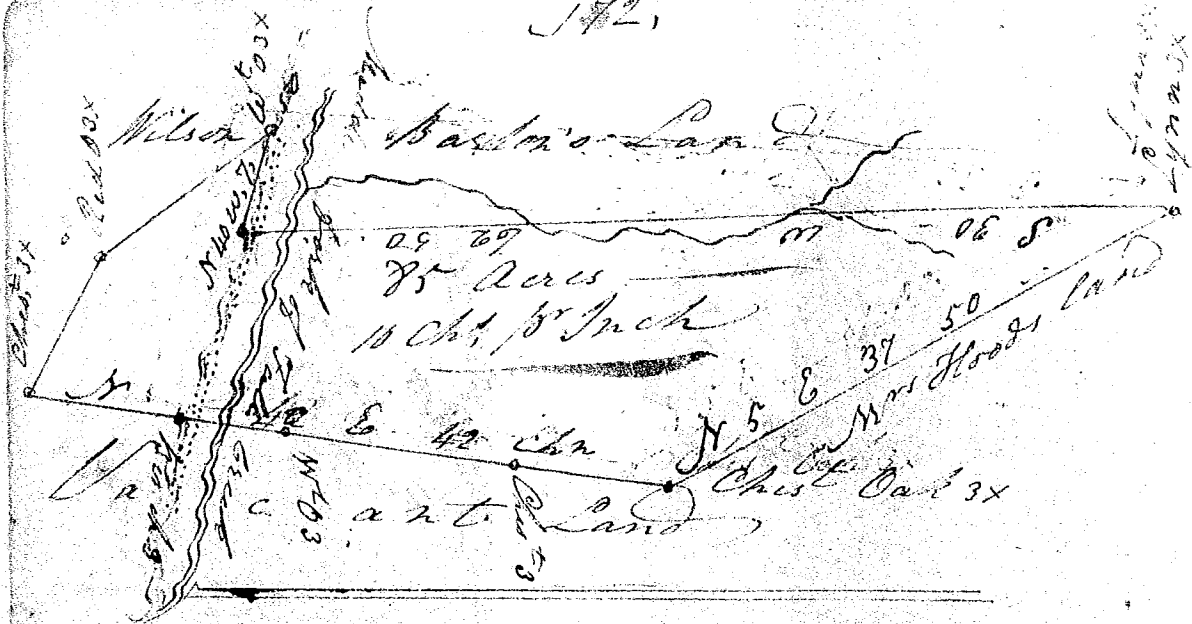

I (Cardinal  
 Co. District) Pursuant to a warrant from Wm  
 Young Esq. Commr. of Locations in the District  
 of Greenville dated the thirty first day of Oct.  
 1833, I have admeasured and laid out unto  
 Wilson Barton a tract of Land on both sides of  
 Fall Creek of the North Fork of Saluda River  
 containing eighty five Acres, and bounding by  
 Lines Running N & E by Vacant Land, and Land  
 of Mrs. Floods, SW, by Wilson Barton's Land, and  
 W. by Hamilton Benefields Land, have  
 being such form and marks, settings and  
 Boundings as the above Plat represents.  
 Surveyed the 30<sup>th</sup> day of Jan<sup>y</sup> 1834 by J. H. H. H.  
 Recorded the 8<sup>th</sup> day of Jan<sup>y</sup> 1834 by  
 John Young, Clerk