

(191)

State of South Carolina
Greenville District

Subscribed to a warrant
from John Wilson Esq. con-
missioner of location for said
district dated the 28th day of
March 1836 I have surveyed
and laid out for said Henry
(for the purpose of subdividing
parts of former grants and
vacant lands) a tract of
land containing thirteen
hundred and thirty three
acres situated in said district
on the waters of Alamo
Creek and Broadwater Creek
of Enoree river, and town
of Newryon, including the
Bala Rock and nearly the
whole of the E. W. line of
New Ben Leonard on
Tanner's mountain and
path with bounds, marks,
buttings & boundaries as
the above plat represent.
Surveyed March 3rd 1836

Recorded March 7th 1836

for
John Wilson
C. S. G.

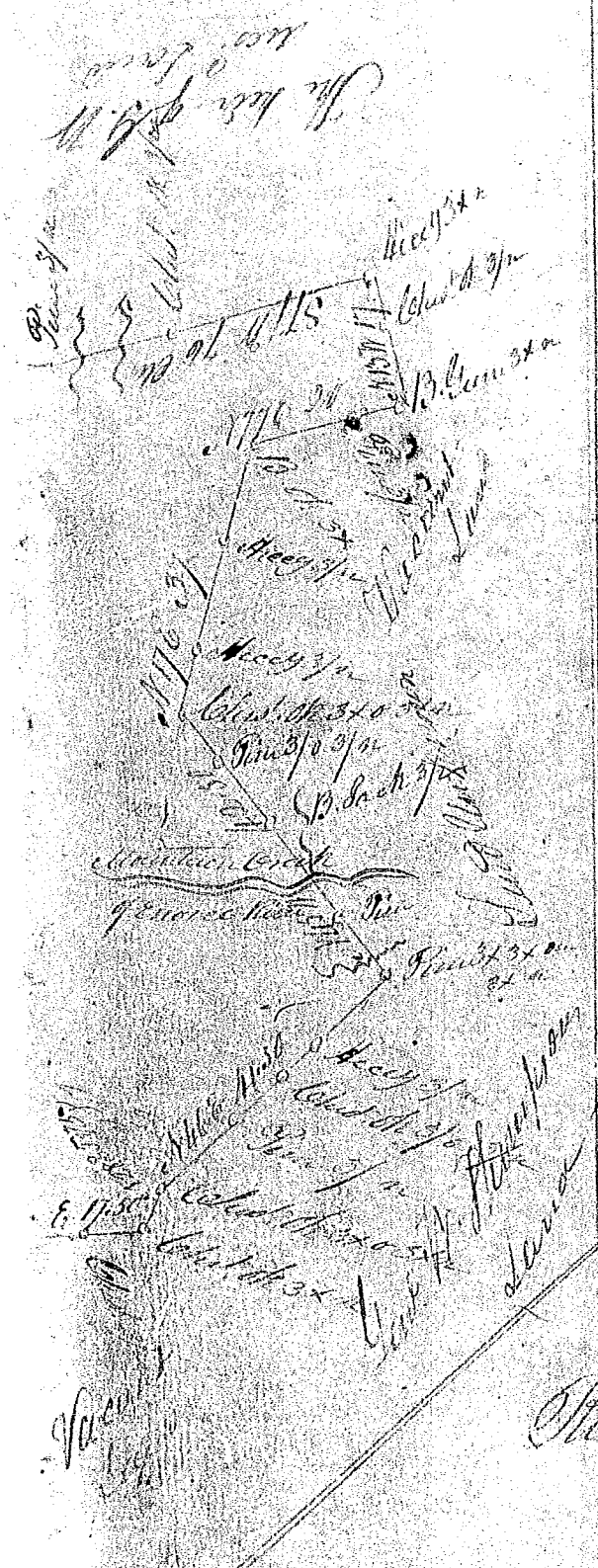

The here of B. G. W.