

4

Laid down by a scale of
10 ch. to an inch

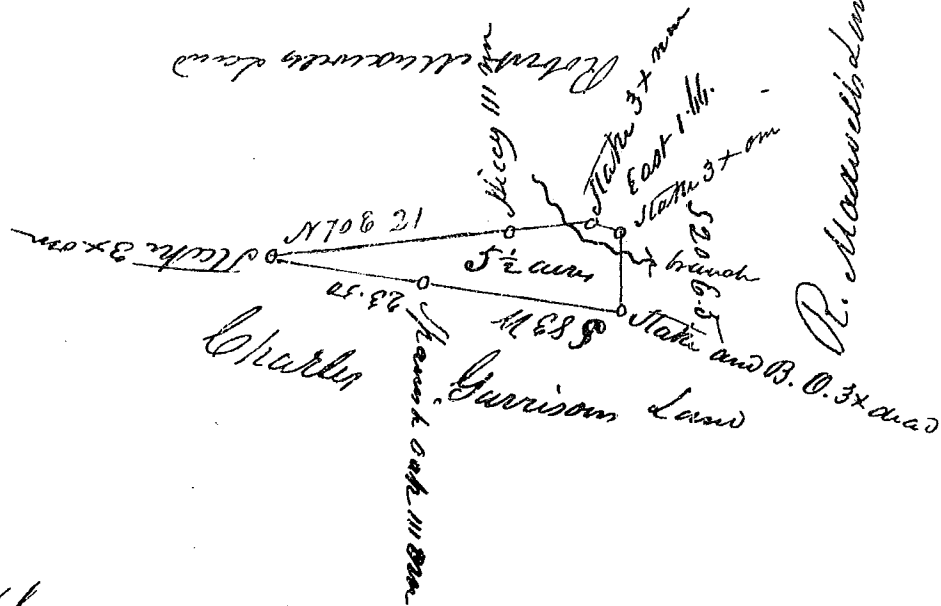

South Carolina }
 Greenville district } I have surveyed and laid out
 unto Mr Robert Maxwell a tract of five and
 a half acres of land lying in the State and district
 aforesaid on a branch of the Golden Groove creek
 waters of Saluda river and hath such form marks
 buttings and bounding as the above plat represents
 Surveyed the 26th Sept. 1838.

5 1/2 ac

By Saml Moore D

Recorded the 5th day of Nov. 1838.

For Geo Watson
 C. S. G. O.