

1841 Filed This 23 day of July 1969
And Recorded in Vol. 4B Page 165 at 2:41 P.
Ollie Farnsworth
Register Mesne Conveyance Greenville County, S. C.

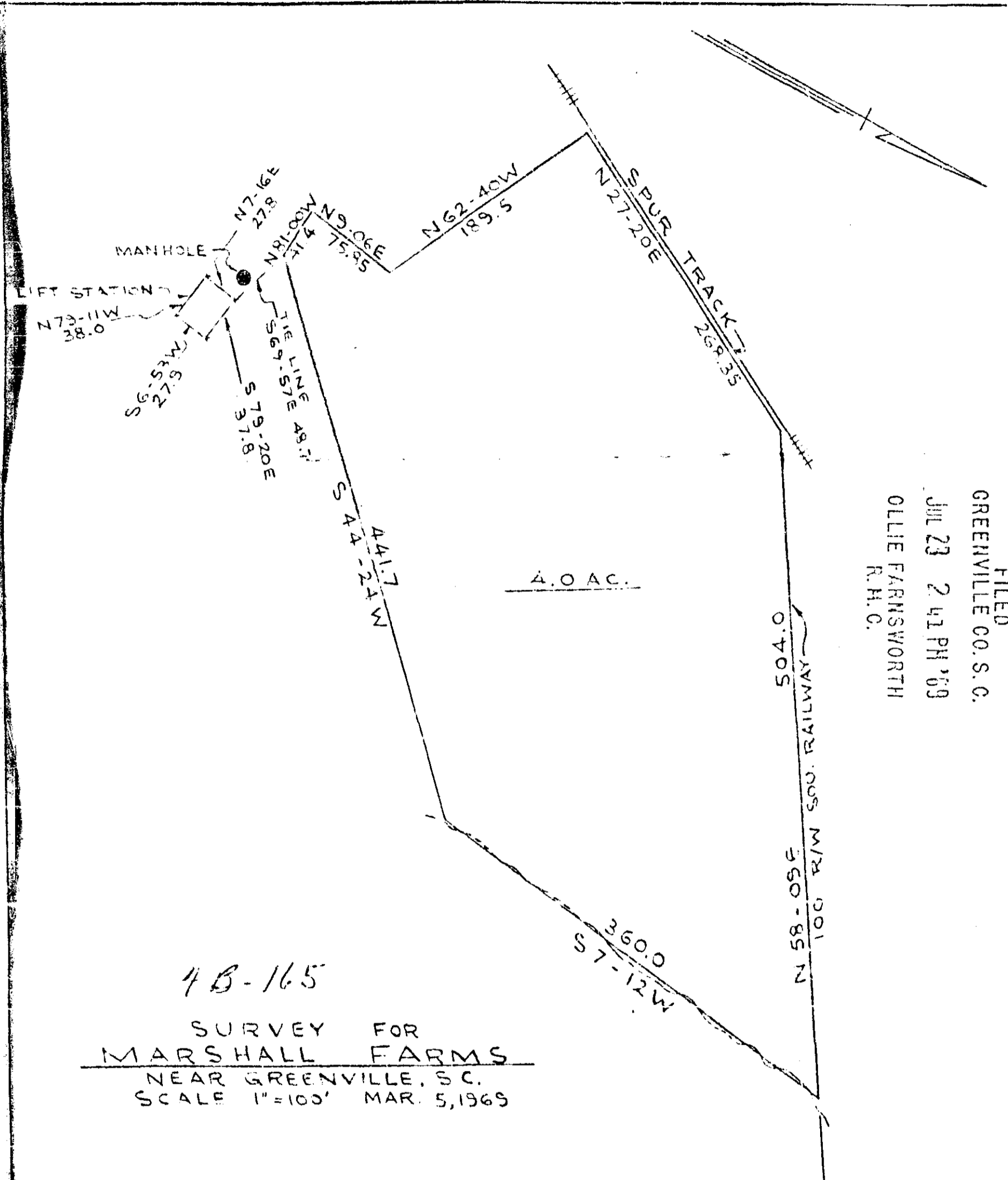

FILED
GREENVILLE CO. S. C.
JUL 23 2 41 PM '69
OLLIE FARNSWORTH
R.H.C.

4B-165
SURVEY FOR
MARSHALL FARMS
NEAR GREENVILLE, S.C.
SCALE 1"=100' MAR. 5, 1969

1841

PIEDMONT ENGINEERS AND ARCHITECTS
GREENVILLE, S. C.

165

