

MAP NO. 1

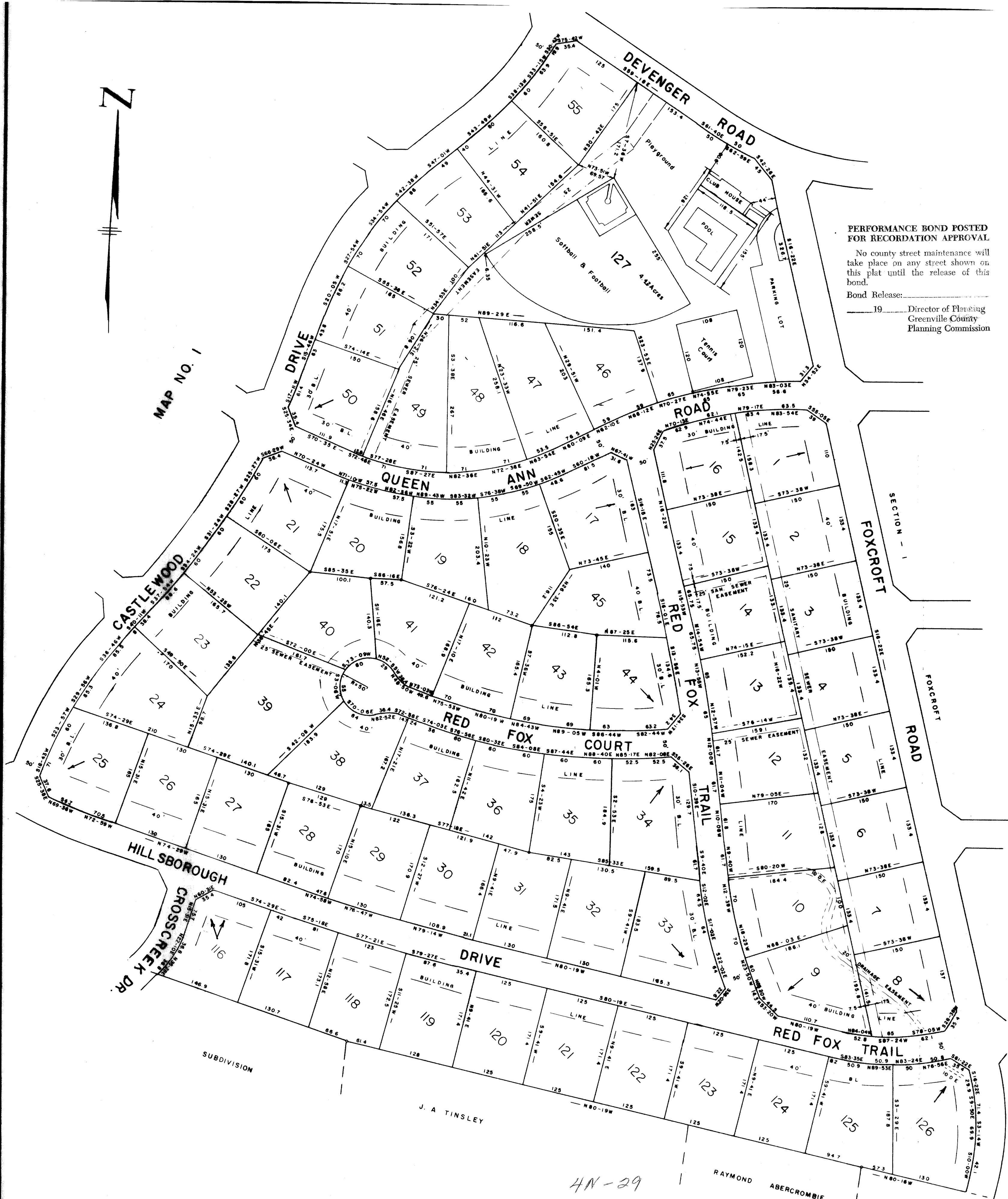

PERFORMANCE BOND POSTED FOR RECORDATION APPROVAL

No county street maintenance will take place on any street shown on this plat until the release of this bond.

Bond Release: _____
19 _____ Director of Planning
Greenville County
Planning Commission

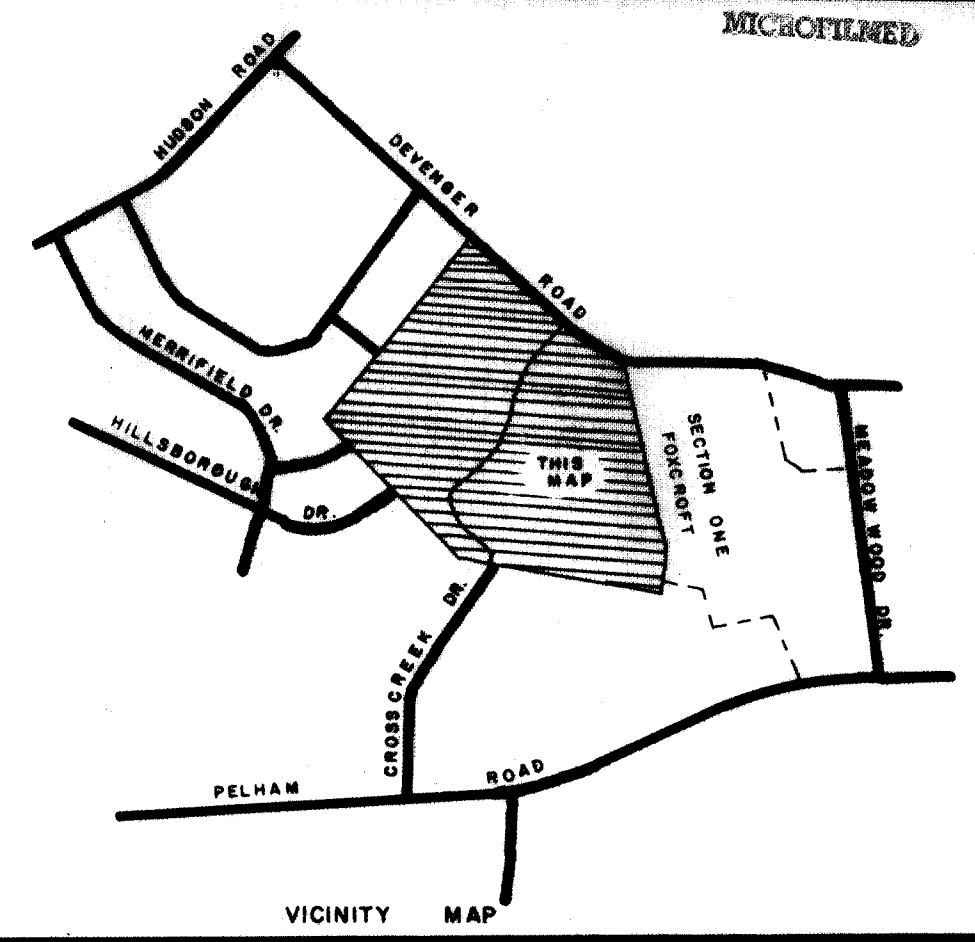

CERTIFICATE OF OWNERSHIP AND DEDICATION

The undersigned hereby acknowledge that I am (we are) the owner(s) of the property shown and described hereon and that I (we) hereby adopt this plan of subdivision with my (our) free consent and that I (we) establish the minimum building restriction lines, and hereby dedicate to public use as roads, streets, and easements, forever all areas so shown or indicated on said plat.

7/30/71 _____ Signed: *John C. Proffitt*

Signed: _____
Signed: _____

CERTIFICATE OF ACCURACY

"I, _____, certify that this plat was (drawn by me) (drawn under my supervision) (an actual survey made under my supervision) from (an actual survey made by me) (deed description recorded in Book _____, Page _____, Book _____, Page _____, etc.) (other); that the error of closure as calculated by latitudes and departures is _____; that the boundaries not surveyed are shown as broken lines plotted from information found in Book _____, Page _____; that this plat was prepared in accordance with the Greenville County Subdivision Regulations as adopted.

7/30/71 _____
Date _____
Licensed Engineer or Registered Surveyor
S. C. Registration No. 1397

CERTIFICATE OF APPROVAL FOR RECORDING

"I hereby certify that the subdivision plat shown hereon has been found to comply with the Subdivision Regulations for Greenville County, with the exception of such variances, if any, as are noted in the minutes of the Greenville County Planning Commission of Greenville County, South Carolina, and that it has been approved for recording in the office of the County Register of Mense Conveyance."

8/20 1971 _____

Greenville County Planning Commission

5372
And Recorded in the _____
4N-29 7/30/71
3:53 P.
AUG 2 1971

FINAL PLAT
FILE NUMBER 71-107

MAP NO. 2
FOXCROFT
SECTION 2

COTHRAN DABY BUILDERS INC.
AND M.G. PROFFITT INC. **C. O. RIDDLE**
OWNER SURVEYOR

NO. OF ACRES	83.56	MILES OF NEW ROADS	1.85
	MAP 1, 2		MAP 1, 2
NO. OF LOTS	127	DATE	7/15/71
	MAP 1, 2		
ERROR OF CLOSURE	1/4,400		

SCALE 1" = 100'
100 0 100 200 300

FILE NUMBER 71-107