

MICROFILMED

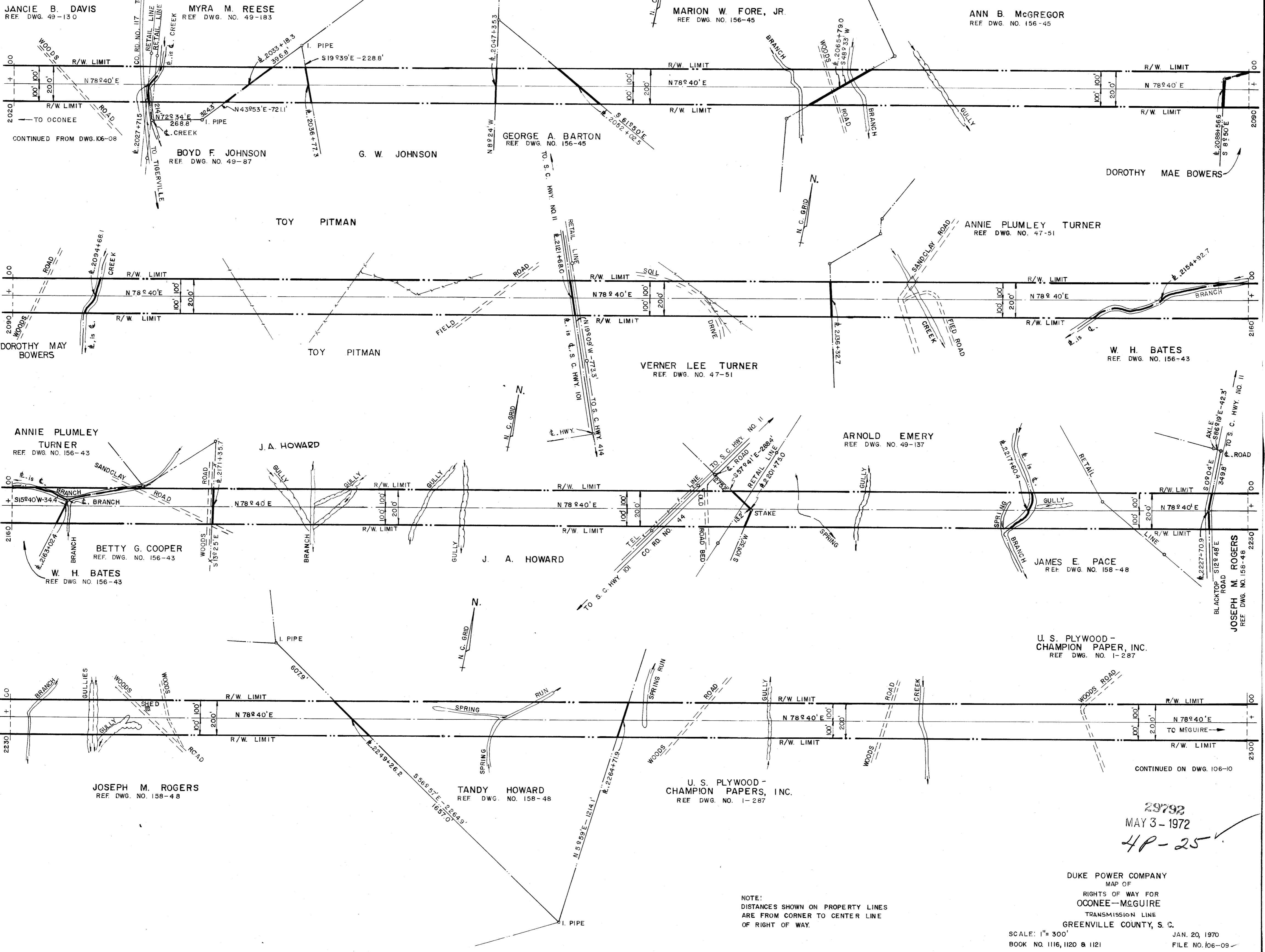

NOTE:
 DISTANCES SHOWN ON PROPERTY LINES
 ARE FROM CORNER TO CENTER LINE
 OF RIGHT OF WAY.

29792
 MAY 3 - 1972
 4P-25

DUKE POWER COMPANY
 MAP OF
 RIGHTS OF WAY FOR
 OCONEE-MCGUIRE
 TRANSMISSION LINE
 GREENVILLE COUNTY, S. C.
 SCALE: 1" = 300'
 BOOK NO. 1116, 1120 & 1121
 FILE NO. 106-09
 JAN. 20, 1970
 300 200 100 0 300 600 900
 SCALE IN FEET

CONTINUED ON DWG. 106-10