

MICROFILMED

- NORWOOD - - GREEN -

N 36-15E →

- 2 -

100

- 3 -

SEPTIC TANK ON LOT

N 53-50 W ↑

150

150
S 53-50 E

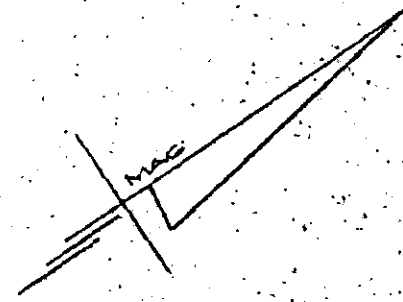
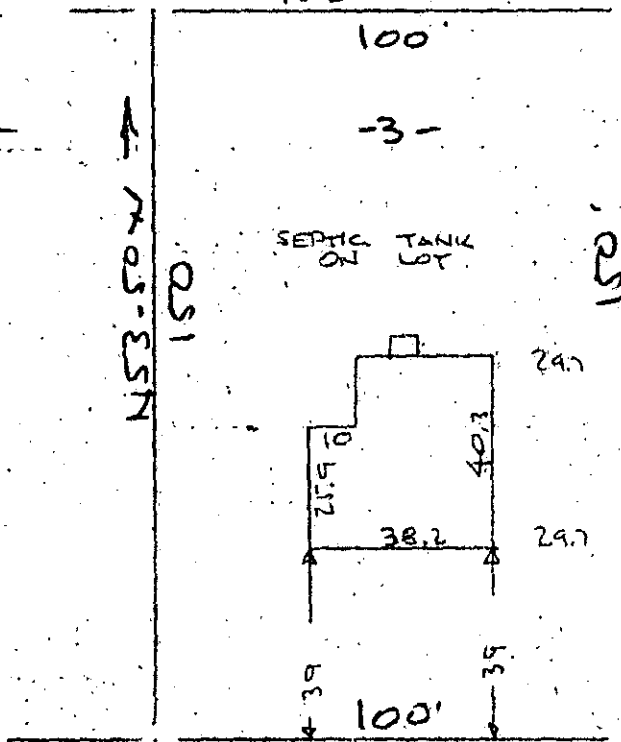

NORWOOD ST.
WATER IN ST. R/W

PROPERTY OF
JAMES PINKNEY BEHELER
NEAR GREENVILLE, S. C.
SCALE: 1" = 40' 2 AUG 1972

This is to certify that on the 2nd day of August 1972, I surveyed the property shown on this plat, being known as lot 3 on plat of JAMES PINKNEY BEHELER and recorded in the RMC Office Greenville County, S.C., in Plat Book 4U at Page 50 ; and that the property lines, walls and buildings are as shown hereon, and that the walls and buildings located on said lot do not encroach or project on adjacent street or property, and that no adjacent walls or buildings encroach or project on said premises, and no power lines cross this property except as shown hereon.

✓ 4-U-50

R. B. Bruce
R. B. Bruce, RLS #1952

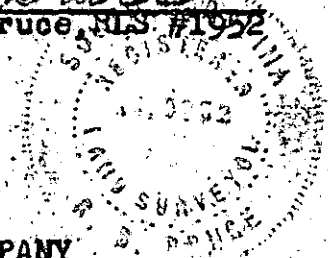

CAROLINA SURVEYING COMPANY
112 Manly St.
Greenville, S. C.