

I.P. N229-00'E BRANCH I.P.

125.0'
PROPERTY OF LEONARD F. & LORENE HICKS

(19)

(20)

(21)

N67°-45'W
189.0'

N67°-45'W
189.5'

0.54

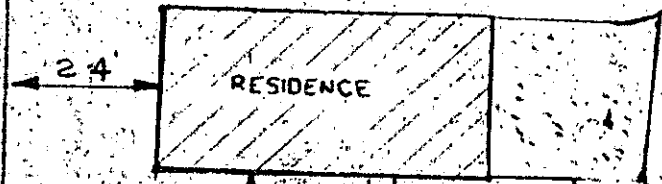

TREE ON PROPERTY LINE

FILED
GREENVILLE CO. S.C.
SEP 29 10 38 AM '72
ELIZABETH RIDDLER
R.M.C.

I.P. S22°-15'W

POWER LINE
WATER LINE

W.M. 125'

P.P. 25'

BENSON DRIVE

SPRINGFIELD SUB-DIVISION

SEP 29 1972

9652

I CERTIFY ABOVE PROPERTY HAS BEEN SURVEYED AND IS AS SHOWN

RLS 4035
SCALE 1"=30'

44-139

RECORDING FEE
PAID \$ 1.00

ORIGINAL PROPERTY RECORDED IN PLAT BOOK XX PG III DEED BOOK 947- PG 313 GREENVILLE COUNTY, BATE TOWNSHIP GREENVILLE, SC

