

MAIN STREET

N 20° 59' 24" E CONC. SIDEWALK 74.9

183.69

83.5 TO R OF W OF SOUTH WASHINGTON ST

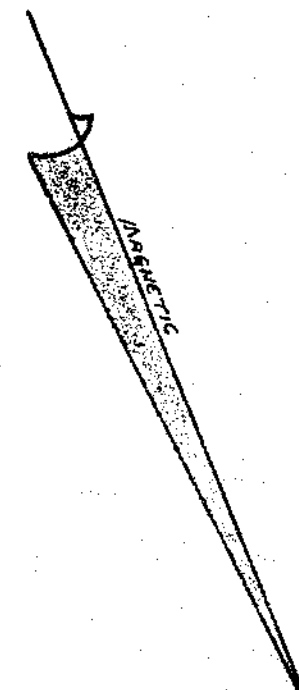

PROPERTY LINE IS NORTHERN FACE OF OLD 13" WALL AND SOUTHERN FACE OF NEW WALL

KRESS BLDG.

THIS IS TO CERTIFY THAT ON NOV 7 1975 AN ON-SITE INSPECTION WAS MADE ON THIS PROPERTY AND NEW STRUCTURES WERE FOUND TO EXIST AS SHOWN HEREON.

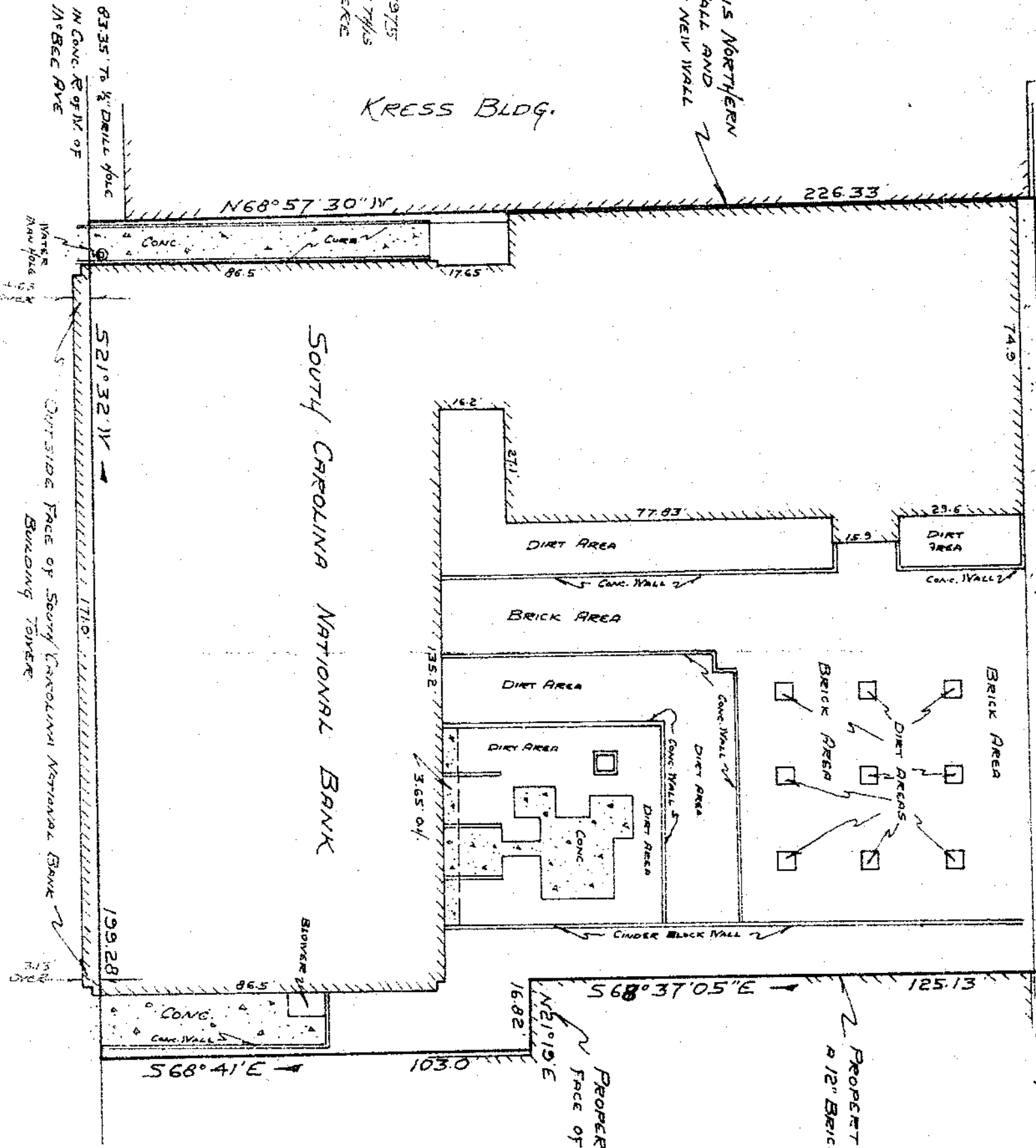

SOUTH CAROLINA NATIONAL BANK

BROWN STREET

16695

DEC 30 1975

AS BUILT SURVEY OF SOUTH CAROLINA NATIONAL BANK GREENVILLE, S.C. SCALE 1"=30' NOV 7 1975

BY CAROL ANN CLARKSON SURVEYOR INC.

FILED GREENVILLE, CO. S.C. DEC 30 4 46 PM '75 DONNIE S. TANKERSLEY R.M.C.

RECORDING FEE PAID \$ 3.00

5-5-88



MICROFILMED