

S. C. HWY. 20
WATER IN RD. R/W

N 4-00 E

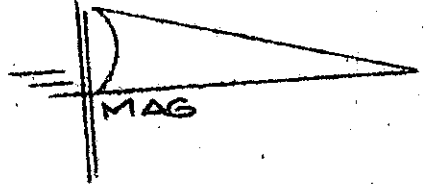
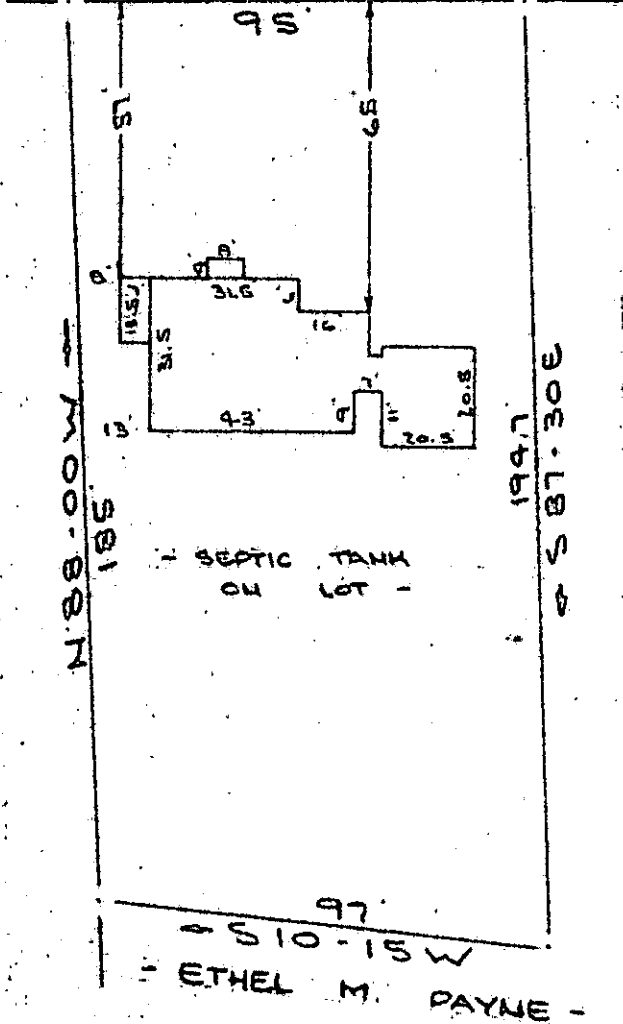

NOTE: Improvements on this lot are not in a flood hazard area.

FILED
GREENVILLE, CO. S. C.
JUL 25 11 05 AM '77
DONNIE S. TANKERSLEY
R.M.C.

KENNETH CAMPBELL

ETHEL M. PAYNE

PROPERTY OF
JAMES CARLTON SMITH
NEAR GREENVILLE, S. C.
SCALE: 1"=40' 25 JULY 1977

This is to certify that on the 25th day of July, 1977, I surveyed the property shown on this plat, being known as PROPERTY OF JAMES CARLTON SMITH and recorded in the RMC Office Greenville County, S. C., in Flat Book at Page and that the property lines, walls and buildings are as shown hereon, and that the walls and buildings located on said lot do not encroach or project on adjacent street or property, and that no adjacent walls or buildings encroach or project on said premises, and no power lines cross this property except as shown hereon.

JUL 25 '77 67-95 ✓ 2609

B. B. Bruce
R. B. Bruce, RLS #1952
SOUTH CAROLINA
LAND SURVEYORS
R. D. BRUCE

E 1.00 AB CAROLINA SURVEYING CO.
112 Hanly St.
Greenville, S. C.

MICROFILMED