

- FOLK - NG3-29E -
100.5

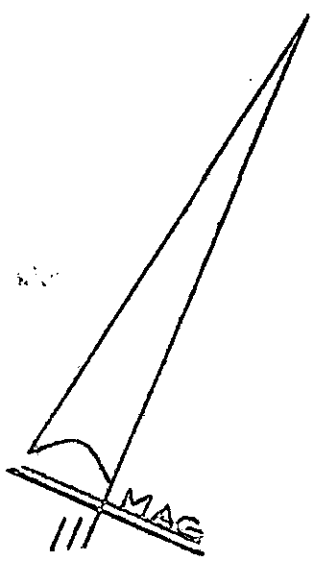

BRIDWELL

NOTE: Improvements on this lot are not in a flood hazard area.

DUKE POWER Co. R/W

PROPERTY OF
JAMES E. JOHNSON
NANCY W. JOHNSON
NEAR GREENVILLE, S. C.
SCALE 1" = 60' GRAPHIC

This is to certify that on the 28th day of April, 1978, I surveyed the property shown on this plat, being known as PROPERTY OF JAMES E. JOHNSON & NANCY W. JOHNSON and recorded in the RMC Office Greenville County, S. C., in Plat Book at Page ; and that the property lines, walls and buildings are as shown hereon, and that the walls and buildings located on said lot do not encroach or project on adjacent street or property, and that no adjacent walls or buildings encroach or project on said premises, and no power lines cross this property as shown hereon.

WELL

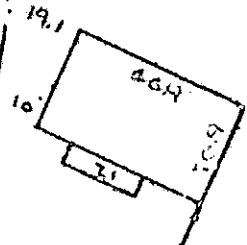

COPYIC TANK

FILED
GREENVILLE, CO. S. C.
APR 28 4 38 PM '78
DONNIE S. TANKERSLEY
R.M.C.

GC10
3-AP28-78
ANU 982

[Signature]
16-0-74 32182

CAROLINA SURVEYING CC.
112 Manly St.
Greenville, S. C.

OLD BRIDGE OF WATER

MICROFILMED

0204-1-9.489.5