

FILED  
GREENVILLE CO. S.C.  
FEB 5 12 25 PM '81  
DONNIE S. TANKERSLEY  
R.M.C.

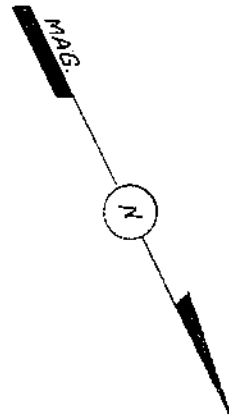

PART LOT 13  
COLONIAL ESTATES

PART LOT 13  
COLONIAL ESTATES

PART LOT 18  
GOWER ESTATES

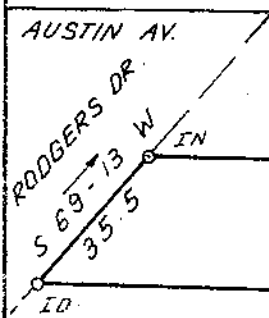

N 61-11 W 268.3

S 61-11 E 328.1

281.1  
S 28-53 W

N 62-10 W 304.1

N 24-39 W 1.8  
N 73-33 E  
N 76-11 E 9.7  
N 97-29 E 32.3

174.3

198.7

I hereby certify that the ratio of  
precision of the field survey is  
1/10,000 as shown hereon and the area  
was determined by the C&M method.  
*James R. Freeland*  
James R. Freeland P.L.S. (S 75 578)

LOT 12

FEB 5 1981  
J-K-26

22350

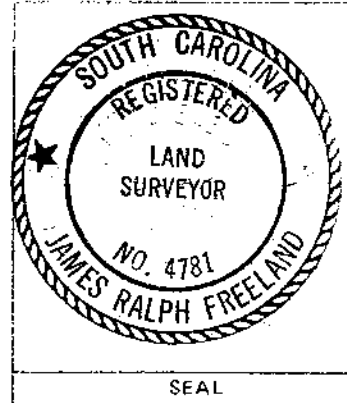
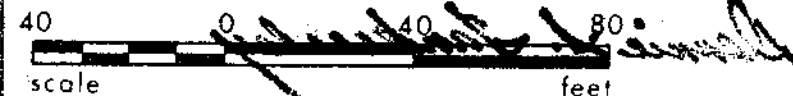

STATE OF SOUTH CAROLINA  
GREENVILLE COUNTY

PROPERTY OF  
DAVID G. ELLISON  
FRANCES D. ELLISON

FREELAND & ASSOCIATES Engineers • Land Surveyors	
GREENVILLE, S.C.	
SURVEY R.P.	
DRAWN B.R.	
CHECK	
SCALE 1" = 40'	
DATE FEB. 4.81	
OWG. NO. 6146	

MICROFILMED