

FILED  
GREENVILLE CO. S.C.

FEB 17 9 35 AM '81

DONNIE S. TANKERSLEY  
R.M.C.

MICROFILMED

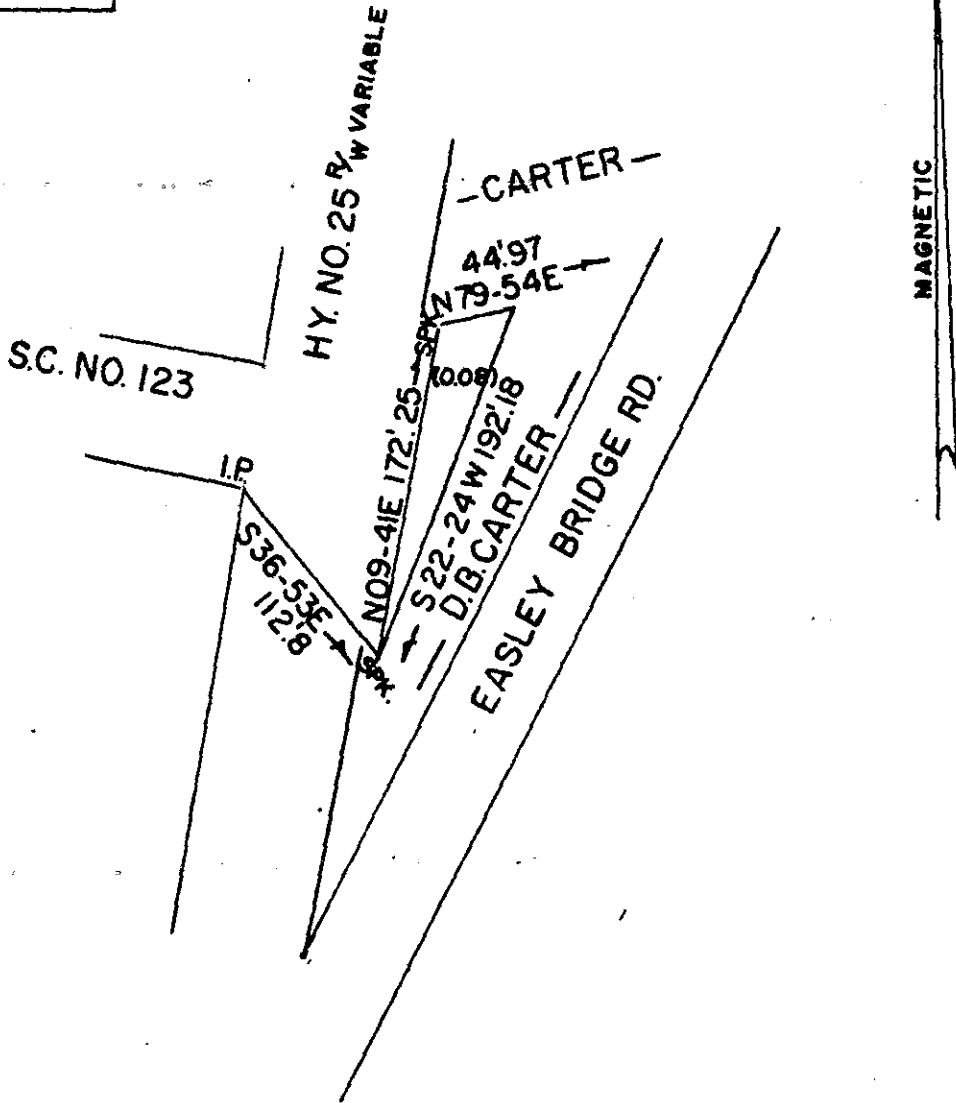
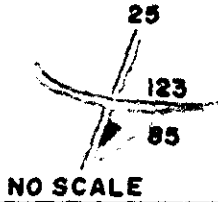

STATE OF SOUTH CAROLINA  
 GREENVILLE COUNTY  
 THE ABOVE PLAT REPRESENTS A PORTION OF PROPERTY OWNED BY THE  
 ESTATE OF MASON RIDDLE.

SURVEYED DEC. 1980  
 JOHN C. SMITH & SON  
 REG. L.S. NO. 1443 & 7882  
 P.O. BOX 732  
 EASLEY, S.C.  
 29640

*JL-64*

23224

FEB 17 1981

It is hereby certified that the ratio of precision  
 of the above survey is 1/10,000 as shown herein  
 and was determined by (D.M.D.) method

1" = 100'

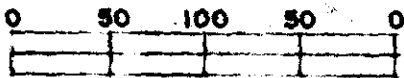

*[Handwritten signature]*  
 304