

THIS PLAT IS NOT A SUBDIVISION  
 AS DEFINED BY THE GREENVILLE  
 COUNTY SUBDIVISION REGULATIONS.  
 8/11/81 *F. J. Fisher*  
 Chairman, Secretary, or Director of  
 Planning,  
 Greenville County Planning Commission

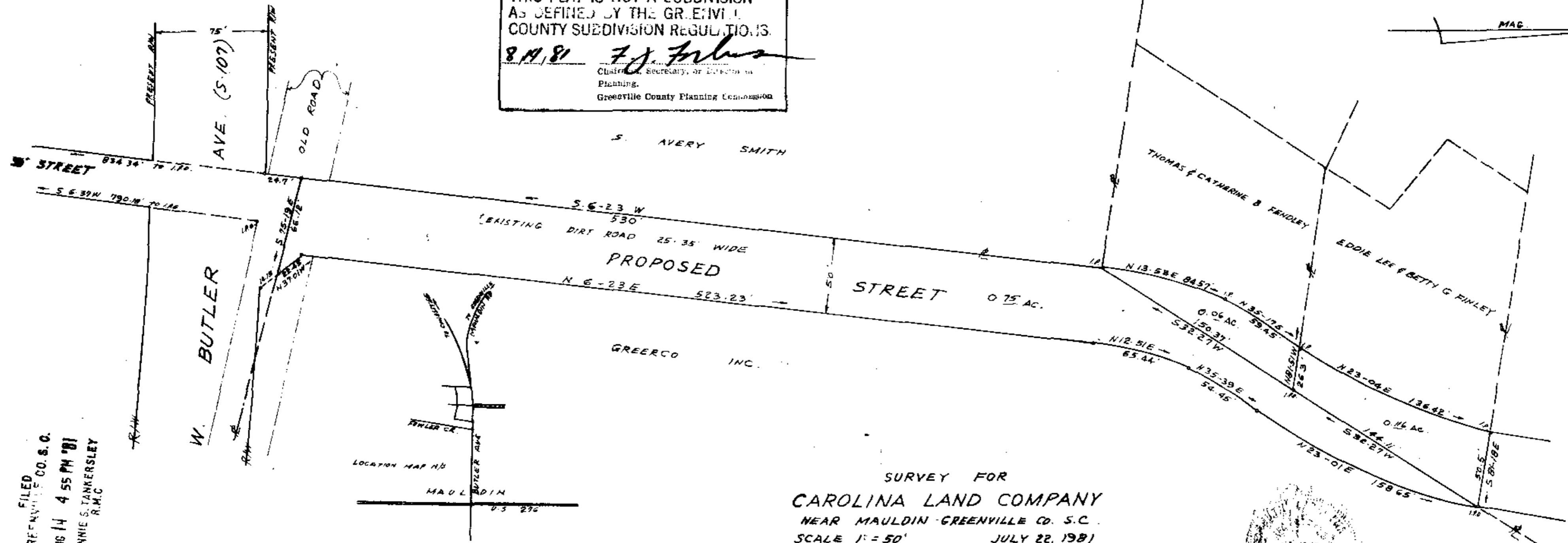
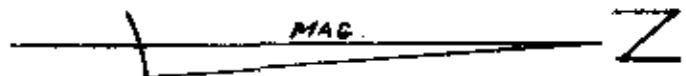

SURVEY FOR  
**CAROLINA LAND COMPANY**  
 NEAR MAULDIN - GREENVILLE CO. S.C.  
 SCALE 1" = 50' JULY 22, 1981

FILED  
 GREENVILLE CO. S.C.  
 AUG 14 4 55 PM '81  
 DONNIE S. TANKERSLEY  
 R.M.C.

I CERTIFY THAT THE RATIO OF PRECISION OF THE FIELD  
 SURVEY IS 1/10,000 AND AREA WAS COMPUTED BY DMD METHOD



C. O. Reddick, P.L.S. #1327 Greenville, S.C.

AUG 14 1981  
 4216  
 8-N-90