

MICROFILMED

LOT 471

LOT 472

FILED 33-51-32E 100.13'

GREENVILLE CO. S.C.

AUG 21 11 10 AM '81

SEWER EASEMENT

DONNIE S. TANKERSLEY
R.M.C.

LOT
481

RECEIVED
JUL 31 1981
RECEIVED
ZONING DEPARTMENT

CHAIN
LINK
FENCE

S 53-43-52E

LOT 480

LOT 482

N 53-43+52W 152.37'

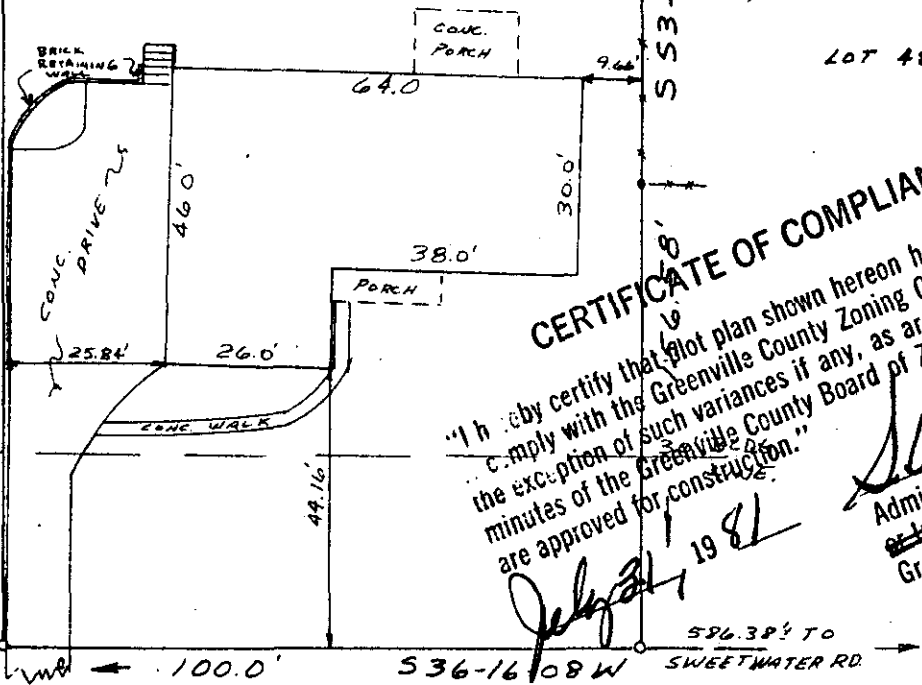

CERTIFICATE OF COMPLIANCE

"I hereby certify that the plot plan shown hereon has been found to comply with the Greenville County Zoning Ordinance, with the exception of such variances if any, as are noted in the minutes of the Greenville County Board of Zoning Appeals, and are approved for construction."

July 31, 1981

[Signature]
Administrator, ~~Secretary~~
Greenville County Zoning Administrator

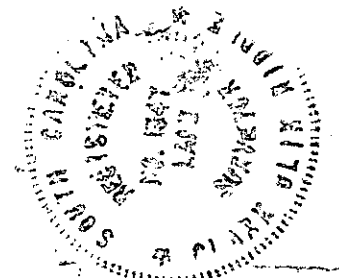

SHADY CREEK COURT

SURVEY FOR
M. G. PROFFITT INC.

NEAR GREENVILLE S.C.

SCALE 1" = 30'

JULY 30, 1981

✓ 88-100 4795

NOTE: THERE IS A 5" DRAINAGE AND UTILITIES EASEMENT EACH SIDE OF ALL SIDE AND REAR LOT LINES.

REF: LOT NO 481 MAP 2, SEC. 2, SUGAR CREEK, RECORDED IN PLAT BK. 7X PAGE 19.

I certify that this is an accurate plat of a survey made by me July 30, 1980 that the improvements located on said premises do not encroach on project on adjacent streets or property, that no easements are visible on the ground except as noted hereon, and that the structure located on said lot is not in a designated 100 year flood plain based on the public records of Greenville County.

[Signature]
C.O. RIDDLE R.L.S. #1347 GREENVILLE, S.C.

5070 --- 1 AU 21 91

640

5000CI