

FILED  
GREENWOOD CO. S.C.  
MAY 16 2 30 PM '82  
DORRIS W. HAMERSLEY  
R.M.C.

M. TROTTER  
1008-835, 54-64

NOTE:  
LINES A, B, C TAKEN FROM PLAT BY MONTGOMERY SURVEYING CO.  
FOR J. RUFFNER, APRIL, 1975. NO SURVEY MADE BY ME OF SAME.

- J. A. ADAIR - (FORMERLY)

- WEST VA. PULP & PAPER CO. -  
568-139, R. BK. LL, Pg. 157

- J. E. SMITH -  
63-375

- ORA & LONA SMITH -  
634-435

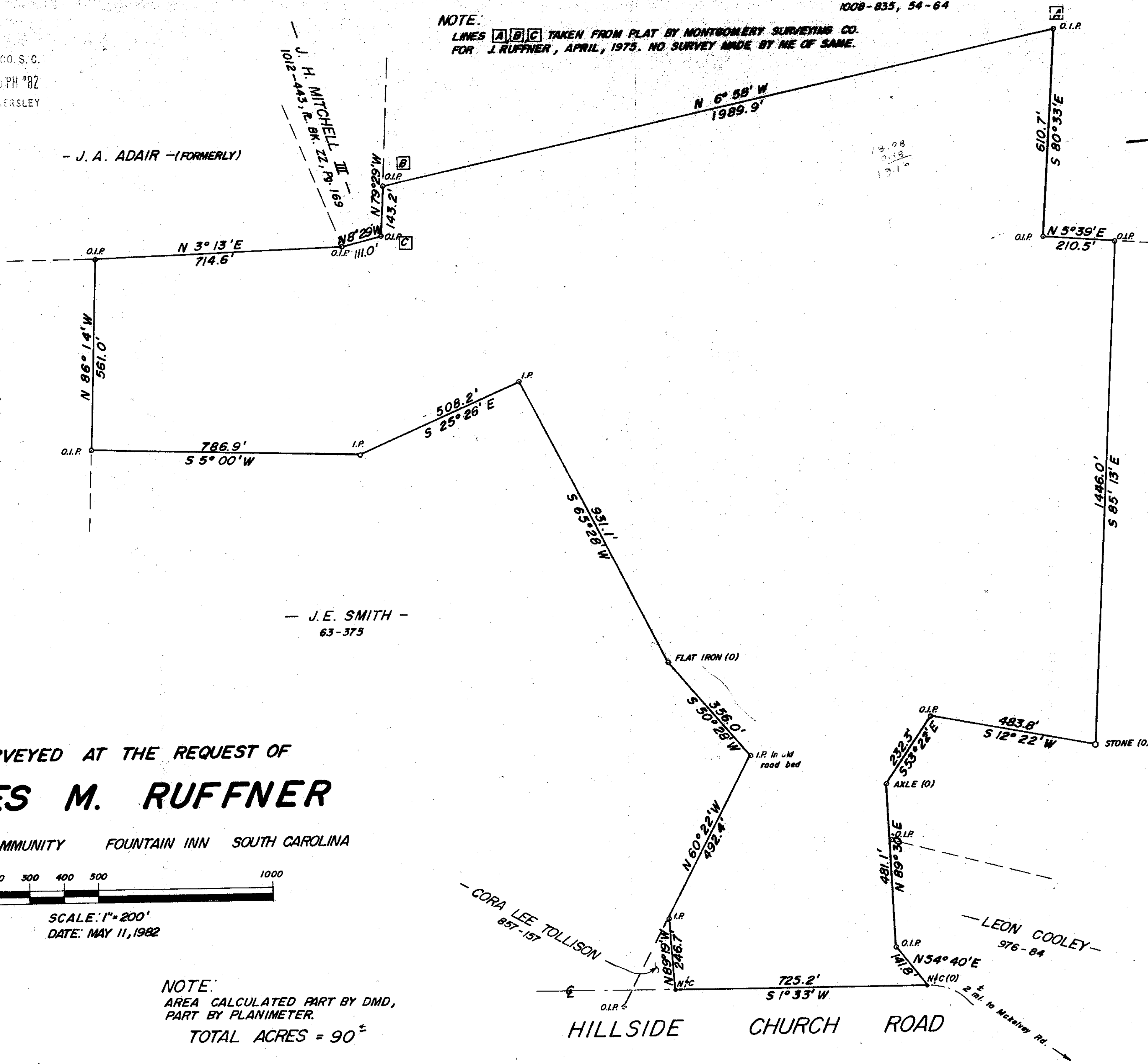

SURVEYED AT THE REQUEST OF  
**JAMES M. RUFFNER**  
HILLSIDE COMMUNITY FOUNTAIN INN SOUTH CAROLINA



SCALE: 1" = 200'  
DATE: MAY 11, 1982

NOTE:  
AREA CALCULATED PART BY DMD,  
PART BY PLANIMETER.  
TOTAL ACRES = 90<sup>±</sup>

- CORA LEE TOLLISON  
857-157

- LEON COOLEY -  
976-84

25674  
MAY 18 1982

HILLSIDE CHURCH ROAD

9-A-21 ✓

*John Woods*  
SURVEYED BY JOHN WOODS, R.L.S. NO. 3380  
FOUNTAIN INN, S.C.