

SEP 30 4 10 PM '82

DONNIE S. TANKERSLEY
R.M.C.

NOTES:

1. THERE IS A _____ UTILITY AND DRAINAGE EASEMENT ALONG EACH SIDE OF ALL SIDE PROPERTY LINES, AND A _____ EASEMENT ALONG EACH SIDE OF REAR PROPERTY LINES.

LOT No. 2

LOT No. 1

0.72 Ac.

CLUB FOREST LANE

CHAPMAN ROAD

CURVE 1
R = 225.0'
L = 184.53'
C = 179.41'
Δ = 46-59-24

CURVE 2
R = 275.0'
L = 32.25'
C = 32.18'
Δ = 6-43-12

MAGNETIC

LOCATION MAP

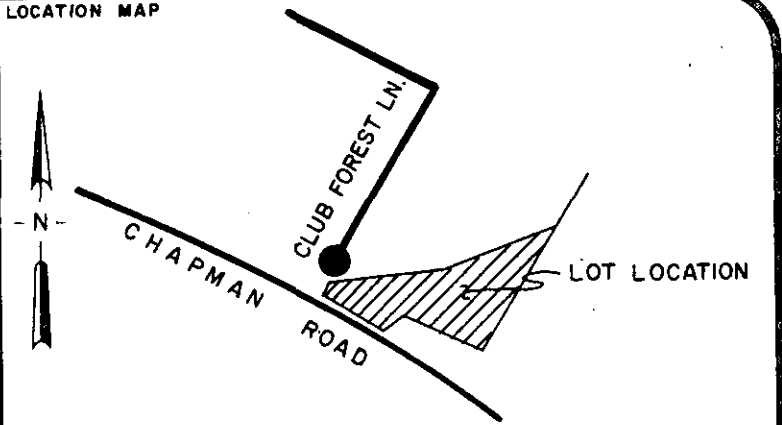

CERTIFICATION:

1. () This is to certify that the bearings and distances, and or measurements, shown on this plat are correct, and that all rights of way, easements, and encroachments, obvious and apparent from field observation of the subject property at the time of the survey are as shown.

2. () This is to certify that the area of the subject property shown on this plat was computed by the coordinate method of area calculation and that this is a CLASS B survey.

3. () The Department of Housing and Urban Development Flood Way Data for Greenville County shows this property () to be in a flood plain, () not to be in a flood plain, () location cannot be determined.

William N. Eason
SIGNATURE OF REGISTERED LAND SURVEYOR DATE 9/22/82 S.C. REG. NO. 7261

REFERENCES

PB	DBI049-958-61	BB
PB	DB	BB
PB	DB	BB
PB	DB	BB

REVISIONS AND RECERTIFICATIONS

NO.	BY	DATE	DESCRIPTION	JOB NO. REFERENCE	APPROVED

PROPERTY SURVEY FOR
COLLEGE PROPERTIES, INC

LOCATED ALONG CHAPMAN
ROAD AND CLUB FOREST LANE

GREENVILLE SOUTH CAROLINA

SCALE 0 40 80

1" = 40'

RESEARCH WNS DRAWN WNS CHECK STH DATE 1 SEPT 82

FILE FIELD WORK BY NONE JOB NO. 82153

ARBOR ENGINEERING

P.O. BOX 263, GREENVILLE, S.C.

LANDSCAPE ARCHITECTS-ENGINEERS-LAND SURVEYORS

NOTE:

EXACT LOCATION OF WATER LINE MUST BE DETERMINED BY GREENVILLE WATER SYSTEM.

7907

9-D-91

SEP 30 1982