

MICROFILMED

FILED  
GREENVILLE CO. S. C.  
FEB 14 1 06 PM '83  
DONNIE S. TANKERSLEY  
R.M.C.

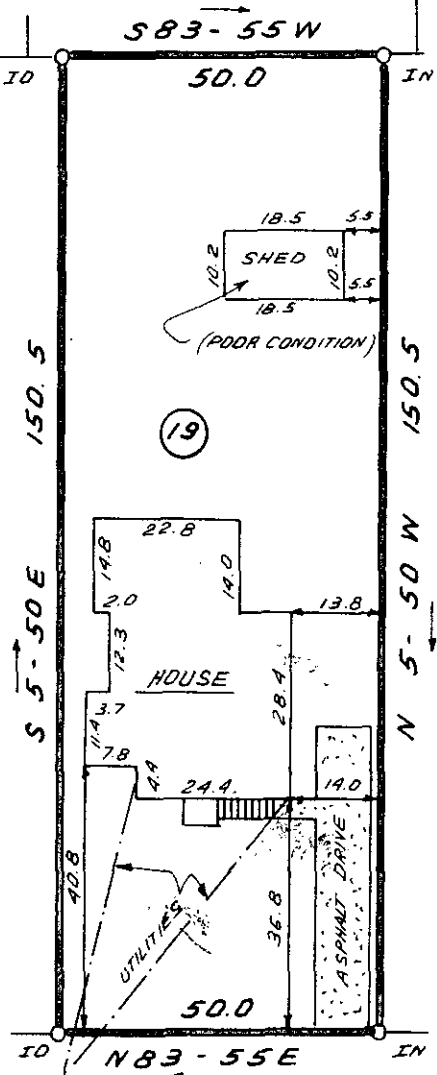

This is to certify that on February 7, 1983, I surveyed the property shown on this plat, known as Lot 19 on the plat of the Property of B.E. Geer recorded in the RMC Office of Greenville County in Plat Book G on page 238, and that the property lines, walls and buildings are as shown hereon; that the building located on said lot does not encroach or project on adjacent streets or property, and that no adjacent walls or buildings encroach or project on said premises, and that no utility lines cross this property except as shown hereon. This property is not located in a designated flood hazard area.

*James R. Freeland*  
James R. Freeland PLS and PE 4781

20109

9-N-14 ✓

FEB 14 1983

**ROGERS AVENUE**

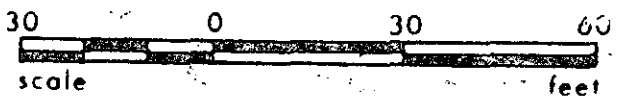

GC10  
2 FEB 14 83

091

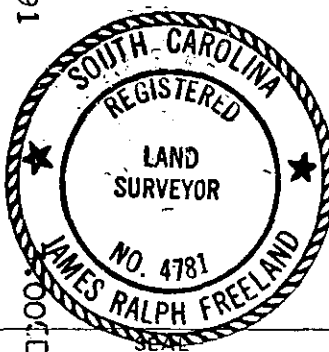

**STATE OF SOUTH CAROLINA  
GREENVILLE COUNTY**

B. E. GEER PROP.  
LOT 19  
PROPERTY OF  
LEONARD G. HILL

FREELAND & ASSOCIATES  
Engineers • Land Surveyors

GREENVILLE, S.C.

SURVEY	L.T.
DRAWN	B.R.
CHECK	MC
SCALE	1" = 30'
DATE	FEB. 7. 83
DWG. NO.	8389