

MICROFILMED

N/E G.P. CRAW -

N/E CHARLES & C. BURRELL -

FILED 571-10E 200.1

GREENVILLE CO S.C

AUG 11 4 27 PM '83

DONNIE S. TARRERSLEY R.M.C

MAG 1982

N/W D. DEERWINE CRAW -

N 40 - 21E 360.8' TOT 331.2'

2.12 ACRES

SEPTIC TANK ON LOT

333.9' 515-16W

Note: Improvements on this lot are not in a flood hazard area.

AUG 11 1983

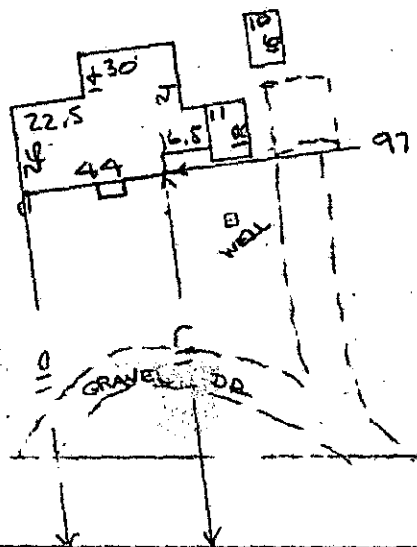

320'± TO FEYS BR. RD

353.3' N71-33W GROCE MEADOW RD.

PROPERTY OF H. KENNETH BAYNE JR & SHERRY E. BAYNE NEAR GREENVILLE, S.C. CO. BALD 1983

This is to certify that on the 8th day of August, 1983, I surveyed the property shown on this plat, being as 2.12 acres on plat of PROPERTY OF DOROTHY G. HART and recorded in the REC Office Greenville County, S. C., in Plat Book " 9 - D " at Page 78 and also known as PROPERTY OF H. KENNETH BAYNE, JR. & SHERRY E. BAYNE recorded in Plat Book of Page ; and that the property lines, walls and buildings are as shown hereon, and that the walls and buildings located on said lot do not encroach or project on adjacent street or property, and that no adjacent walls or buildings encroach or project on said premises, and no power lines cross this property except as shown hereon.

3.0001

9Y-71

5052

CAROLINA SURVEYING CO. 112 Hanly St., Greenville, S.C.

CAROLINA SURVEYING CO. 1983