

TO HWY. 290 N 61 - 10 E - 110.0

S. C. HWY. NO. 293

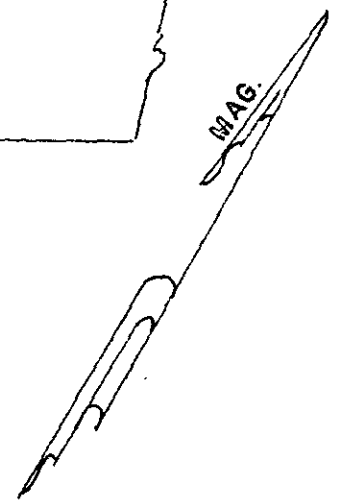
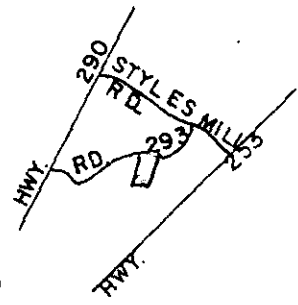

400.0

400.0

1.0 AC.

N 34 - 47 W

S 34 - 47 E

HUFF W. E.

FILED
GREENVILLE CO. S.C.
SEP 21 12 00 PM '83
DONNIE S. JAMES/ERSLEY
R.M.C.

9579

SEP 21 1983

9-2-98

PLAT FOR

DAVID O HUFF
ELIZABETH W HUFF
NEAR TRAVELERS REST
GREENVILLE COUNTY S. C.
WEBB SURVEYING & MAPPING CO.
SCALE 1" = 50' SEPT. 1983

CHARLES F. WEBB
REGISTERED
LAND SURVEYOR
SOUTH CAROLINA

CHARLES F. WEBB
REGISTERED
1577
LAND SURVEYOR
SOUTH CAROLINA

300 8 5371801