

FILED
GREENVILLE CO. S. C.

DEC 1 2 40 PM '83

DEC 1 1983
DORRIS J. ANNE SLEY
R.M.C.

NOTE: IN D.B 618-p. 182 H. W. GOSNELL
CONVEYED TO H.R. FISHER .15 AC. ±, ON
PLAT FOR HARRY W. GOSNELL BY THIS
OFFICE 9-4-1980 THIS .15 AC. ± WAS
NOT TAKEN OUT. THIS PLAT IS TO
CORRECT GOSNELL PLAT OF 9-4-80.

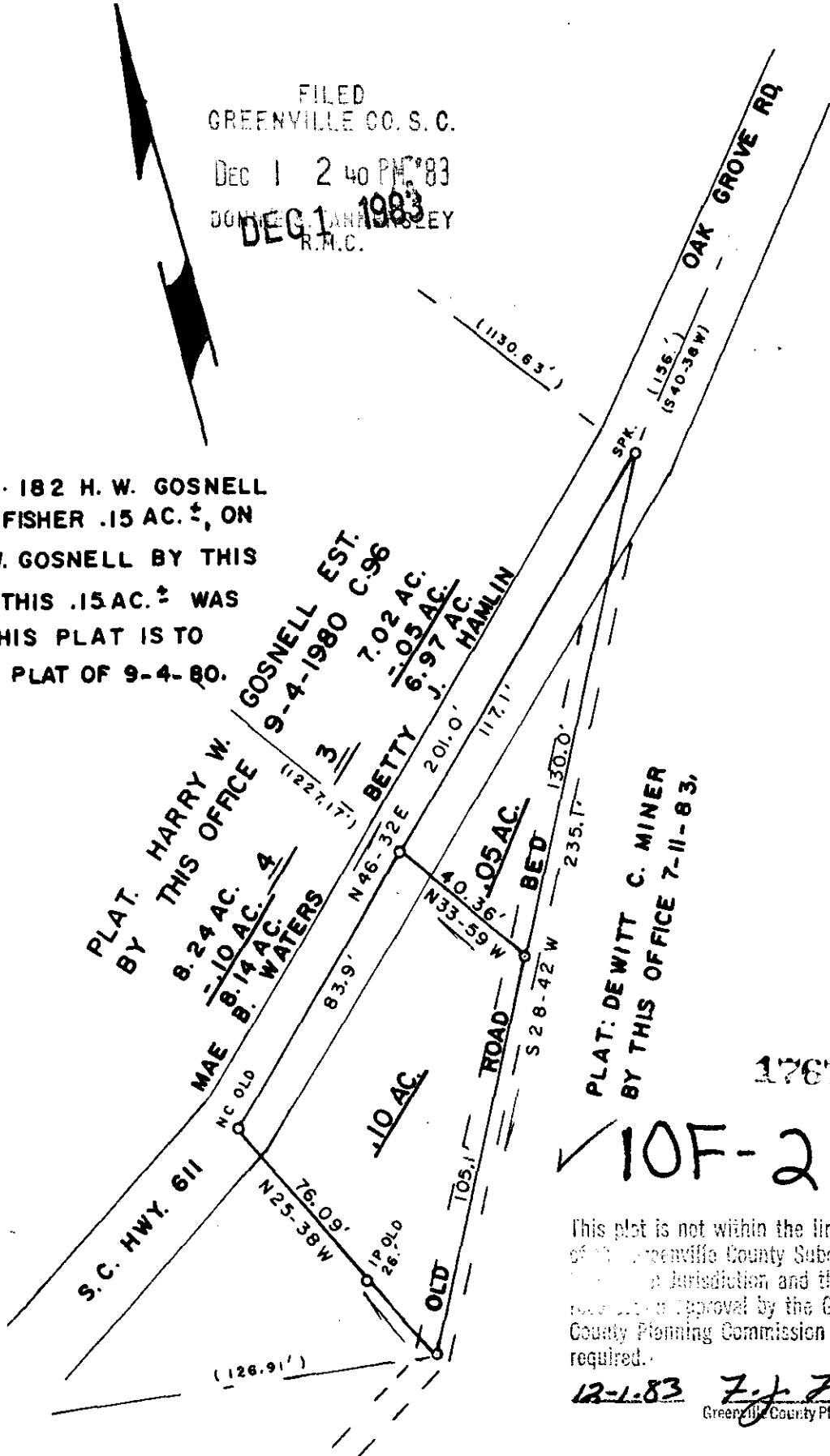

PLAT: DEWITT C. MINER
BY THIS OFFICE 7-11-83,

17677

✓ 10F-2

This plat is not within the limits
of Greenville County Subdivision
jurisdiction and therefore
approval by the Greenville
County Planning Commission is not
required.

12-1-83 *F. J. Fisher*
Greenville County Planning Commission

| | | | | | | | |
|----------------------------------------------------|----------------------|------------------------|------------------------|---------------------------------------------------------------------------------------------|--|-----------------------|--|
| PLAT OF CORRECTION FOR: HARRY W. GOSNELL | | | | SURVEYED BY JAMES V. GREGORY, R.L.S. RT. 3 - BOX 237 CAMOBELLO, S. C. 29322 | | | |
| LOCATION: NEAR OAK GROVE CHURCH | | | | | | | |
| COUNTY: GREENVILLE | | STATE: S. C. | E/S: 1/6,500 | | | AREA BY DMD | |
| CO. BLK. MAP REF.: | D/B REF.: | P/B REF.: | | | | | |
| 6-25.1-1-12 | 618 p.182 | 618 p.182 | | | | | |
| DATE: JULY 19, 1983 | scale 40 0 40 80 | | | | | | |
| | | | | REGISTRATION # 6329 MEMBER S. C. SOCIETY OF REGISTERED LAND SURVEYORS | | | |