

OLD GROVE ROAD

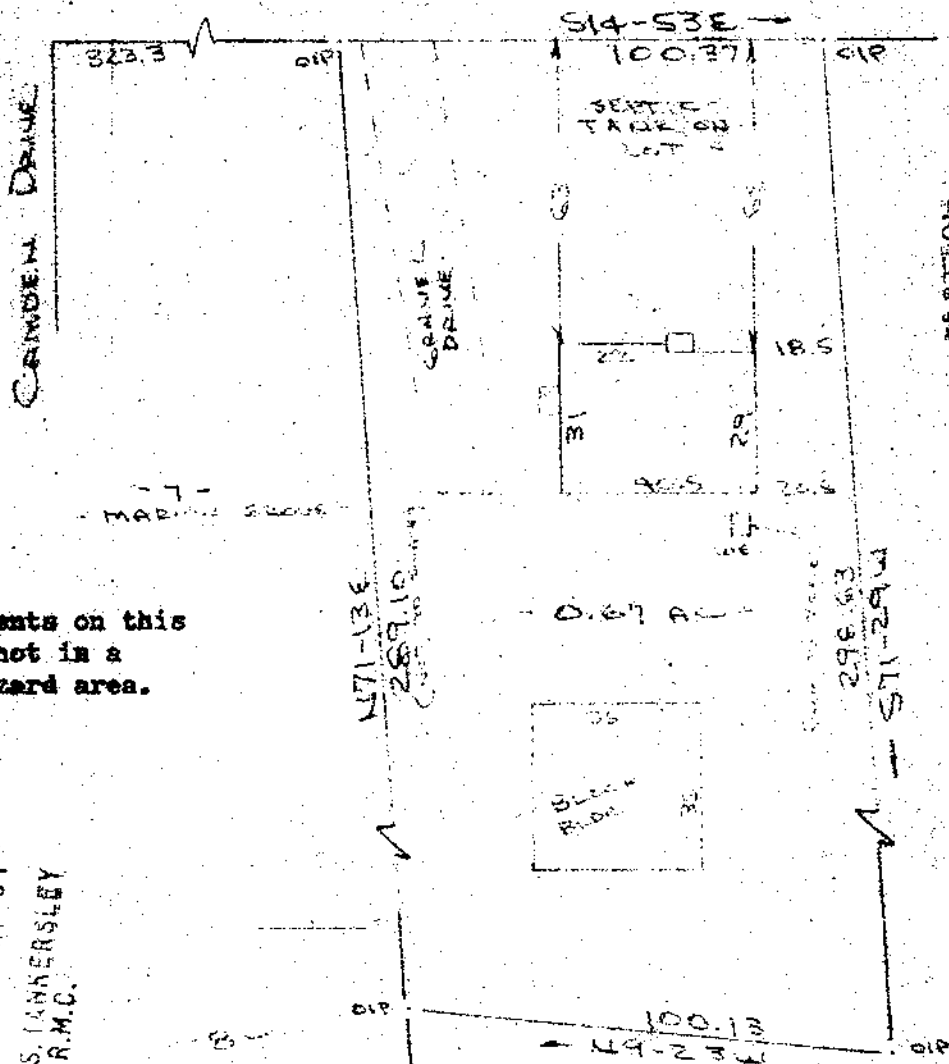

Note:
Improvements on this
lot are not in a
flood hazard area.

FILED
GREENVILLE CO. S. C.
MAY 23 10 30 AM '84
DONNIE S. LANNERSLEY
R.M.C.

PROPERTY OF
JIMMIE A. CULBERTSON & CAROLYN F. CULBERTSON
NEAR GREENVILLE GREENVILLE COUNTY, S.C.
21 MAY 1984

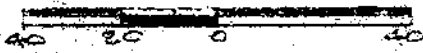

This is to certify that on the 21st day of May, 1984, I surveyed the property shown on this plat, being known as 0.67 acres on plat of JIMMIE A. CULBERTSON & CAROLYN F. CULBERTSON and recorded in the RMC Office Greenville County, S. C., in Plat Book _____ at Page _____; and that the property lines, walls and buildings are as shown hereon, and that the walls and buildings located on said lot do not encroach or project on adjacent street or property, and that no adjacent walls or buildings encroach or project on said premises, and no power line cross this property except as shown hereon.

10-P-90 36861

R. B. Bruce
R. B. Bruce, 216 S. 1st St.
Greenville, S. C.

MAY 23 1984

CAROLINA SURVEYING CO.
112 Manly St.
Greenville, S. C.

Recordable Plat

100 2 1801