

GLACIER STREET
WATER & SEWER IN ST R/W

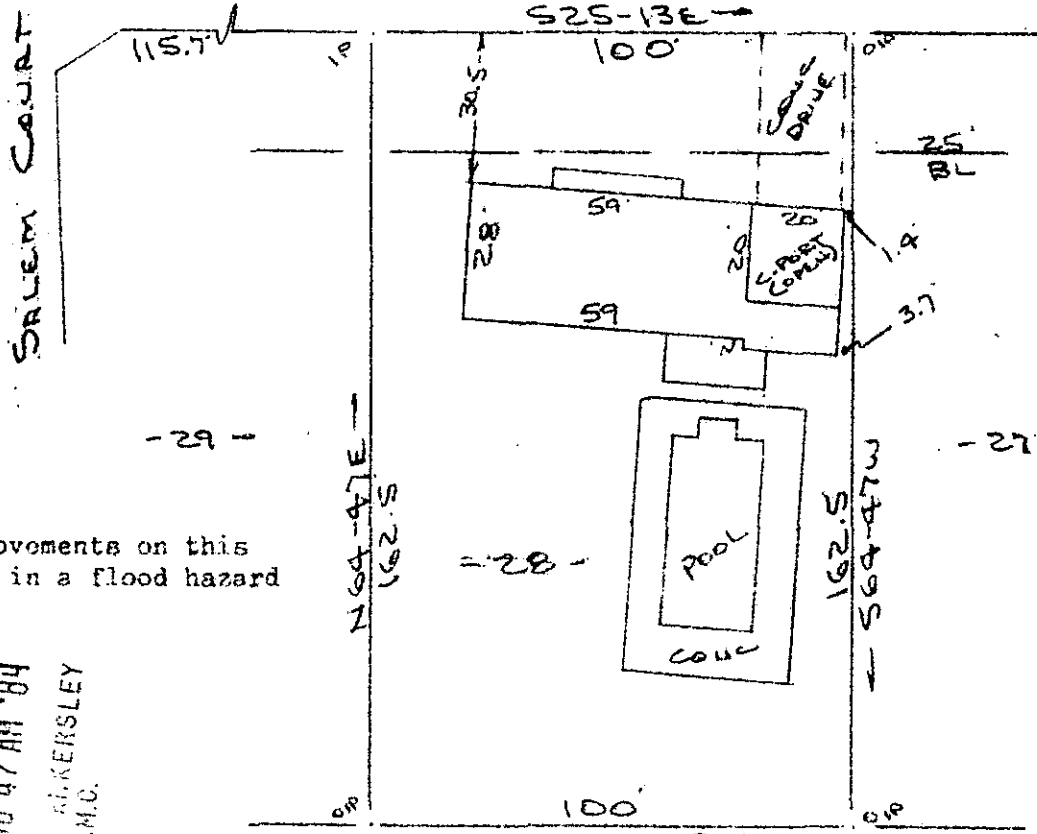

Note: Improvements on this lot are not in a flood hazard area.

FILED
GREENVILLE CO. S.C.
NOV 19 10 47 AM '84
DONNIE S. RICKERSLEY
R.M.C.

PROPERTY OF
TEDDY LYNN HICKS & CATHERINE N. HICKS
NEAR GREENVILLE, S.C.
SCALE: 1" = 40' 14 NOV. 1984

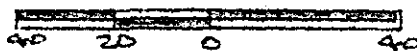

This is to certify that on the 14th day of November, 1984, I surveyed the property shown on this plat, being known as lot 28 on plat of PROPERTY OF WM. R. TIMMONS, JR. and recorded in the RMC Office Greenville County, S. C., in Plat Book "MM" at Page 127; and that the property lines, walls and buildings are as shown hereon, and that the walls and buildings located on said lot do not encroach or project on adjacent street or property, and that no adjacent walls or buildings encroach or project on said premises, and no power lines cross this property except as shown hereon.

11-C-38 15284

R. B. Bruce, R.M.C.

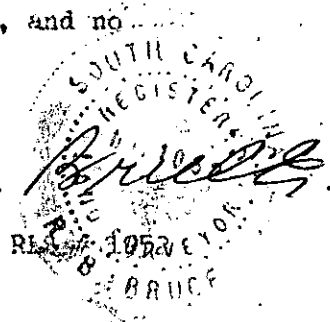

CAROLINA SURVEYING CO.
112 Manly St.
Greenville, S. C.

Recordable Plat

2 NO 19 84 348 3.0001