

Note:
Improvements on this lot are not in a flood hazard area.

FILED
GREENVILLE CO. S.C.
JAN 31 2 02 PM '85
DONNIE S. JANKERSLEY
R.M.C.

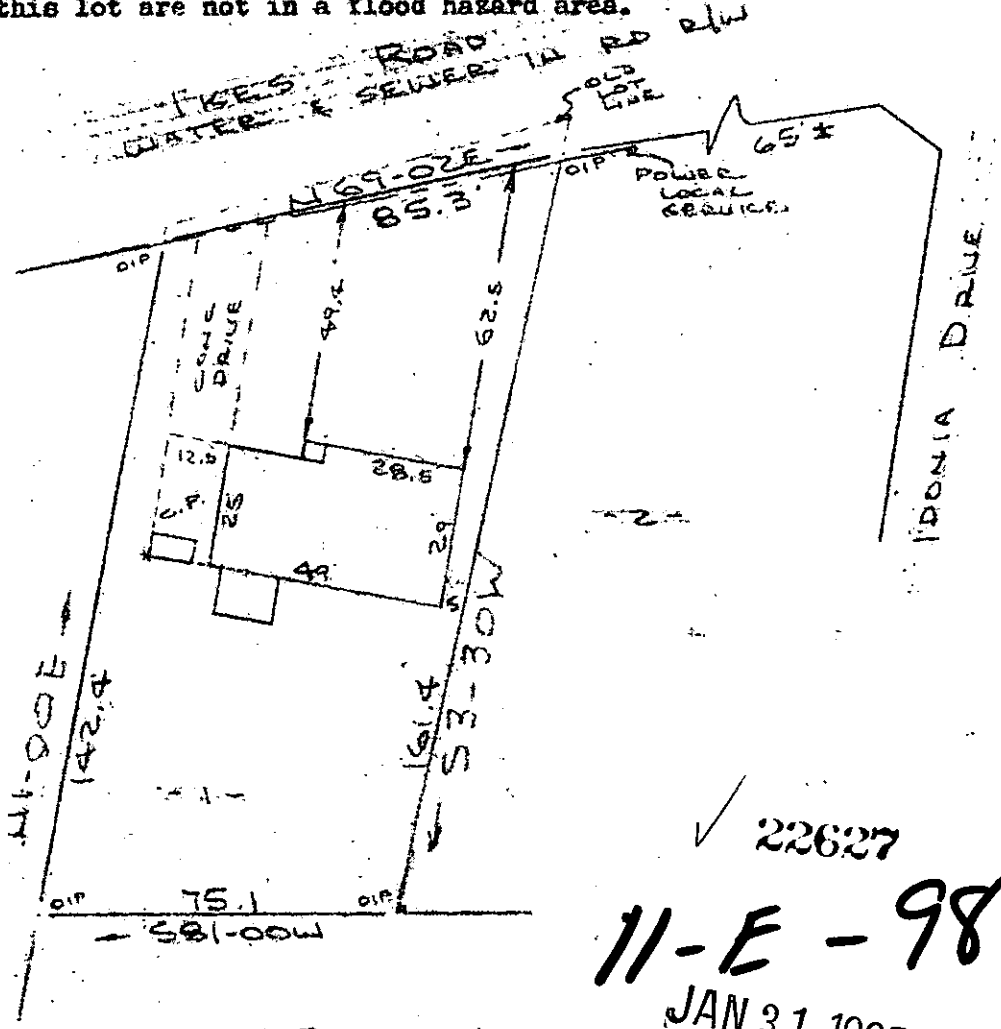

✓ 22627
11-E-98
JAN 31 1985

PROPERTY OF
DAVID A. TALLEY & SHERRI S. TALLEY
NEAR GREENVILLE, GREENVILLE COUNTY, S.C.
SCALE: 1"=40' 24 JAN 1985

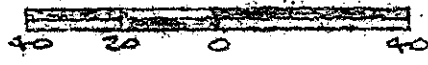

This is to certify that on the 24th day of January, 1985, I surveyed the property shown on this plat, being known as lot 1 on plat of ROSEWOOD PARK and recorded in the EMC Office Greenville County, S. C., in Plat Book "TT" at Page 30; and also being known as PROPERTY OF DAVID A. TALLEY & SHERRI S. TALLEY and recorded in Plat Book at Page ; and that the property lines, walls and buildings are as shown hereon, and that the walls and buildings located on said lot do not encroach or project on adjacent street or property, and that no adjacent walls or buildings encroach or project on said premises, and no power lines cross this property except as shown hereon.

R. B. Bruce
R. B. Bruce, RLS # 1952

CAROLINA SURVEYING CO. Recordable Plat
112 Easley St.
Greenville, S. C.