

FILED  
GREENVILLE CO., S.C.  
AUG 8 10 43 AM '85  
DONNIE S. TANKERSLEY  
R.M.C.

BELYUE ROAD

MOUNTAIN CREEK

H 82-19 W  
H 82-203

WHITWORTH  
W 7-32 E  
148.2

WARD  
219.6  
71.4

SEPTIC TANK ON LOT

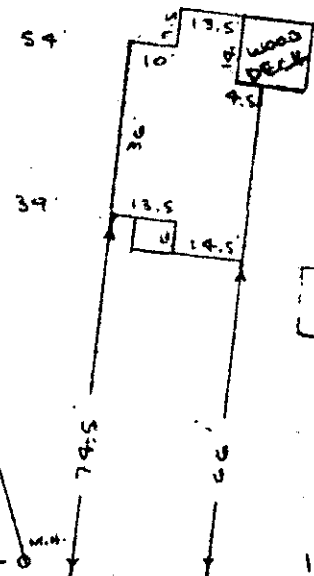

GARAGE

GRAVEL DRIVE

MARTHA JONES (LIFE EST.)  
S 57-18 E  
261.6

295

SEWER

S 24-44 W

PIEDMONT PARK ROAD  
(MOUNTAIN CREEK ROAD)  
WATER IN ST. R/W

11-U-42

4078

AUG 8 1985

PROPERTY OF  
GARY TED BURGESS & NAOMI S. BURGESS

NEAR GREENVILLE, S. C.  
SCALE: 1" = 40' 5 AUG 1985



This is to certify that on the 5th day of August, 1985, I surveyed the property shown on this plat, being known as PROPERTY OF CLARENCE B. JONES and recorded in the REC Office Greenville County, S. C., in Plat Book " 7 - W " at Page 25; and that the walls and buildings located on said lot do not encroach or project on adjacent street or property, and that no adjacent walls or buildings encroach or project on said premises, and no power lines cross this property except as shown hereon.

*R. B. Bruce*  
R. B. Bruce, RES # 1962

CAROLINA SURVEYING CO.  
112 Manly St., Greenville, S. C.

Recordable Plat

SCALE 1" = 40' 5 AUG 1985 509 3.0001