

MICROFILMED

ENOORE COURT
WATER IN ST PLW.

2 MAG
1960

REID SCHOOL ROAD

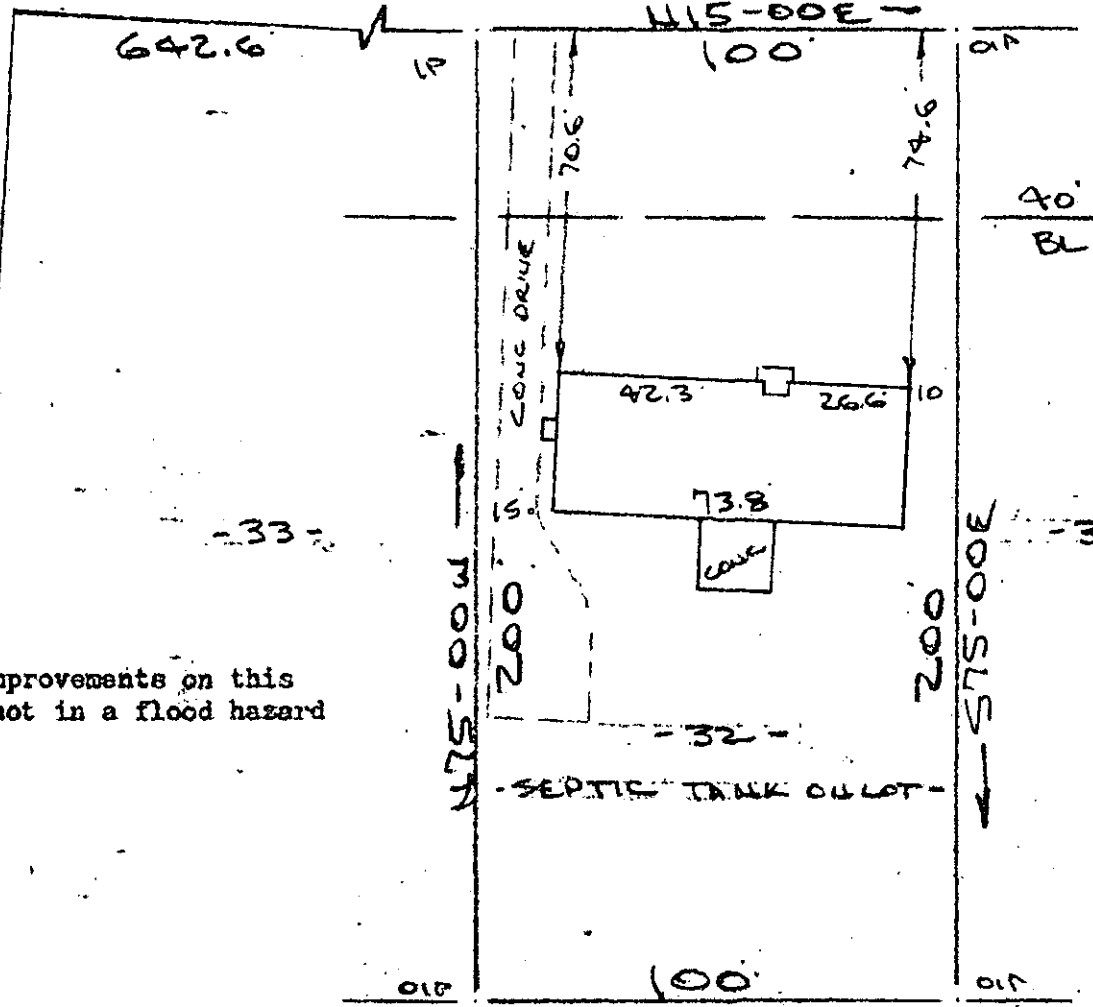

Note: Improvements on this lot are not in a flood hazard area.

PROPERTY OF
DAVID M. HUGHEY
NEAR GREENVILLE S.C.
SCALE: 1"=40' 27 SEPT 1985

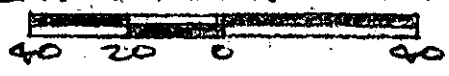

OCT 1 9 29 AM '85
DONNIE S. TANKERSLEY
R.M.C.
FILED
GREENVILLE CO., S.C.
1985

This is to certify on the 27th day of September, 1985, I surveyed the property shown on plat of ENOREE HEIGHTS and recorded in the RMC Office Greenville County, S. C., in Plat Book "RR" at Page 63; and that the property lines, walls and buildings are as shown hereon, and that the walls and buildings encroach or project on said premises, and no power lines cross this property except as shown hereon.

11212

11-y-93

R. B. Bruce

R. B. Bruce, RLS # 1952

CAROLINA SURVEYING CO.
112 Manly St.
Greenville, S. C.

Recordable Plat

275A/49A

T27-1-43

300 8 21001