

FILED
GREENVILLE CO., S.C.

NOV 5 9 59 AM '85
177-31E
262

DORRIS S. TANKERSLEY
107 R.M.C.

CARDINAL DRIVE
WATER IN ST. BLDG

112-29W
135'

112-29W
135'

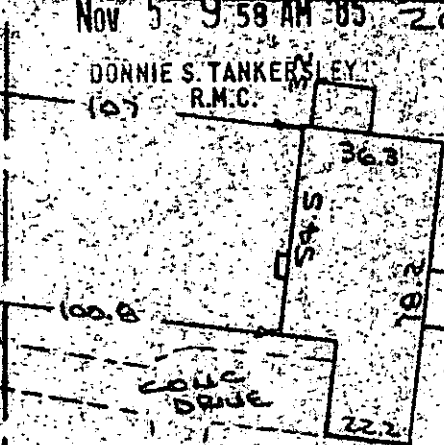

151.5'
381-41S
5118E

UMAG
1980

Note:
5' drainage &
utility easement along
all rear and side lot
lines.

Note: Improvements on
this lot are not in a
flood hazard area.

PROPERTY OF
ROBERT F. HOYT & BENJAMIN ROSCOE MULL
NEAR GREENVILLE, S.C.
SCALE 1" = 50' 4 NOV 1985

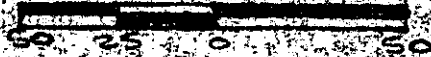

This is to certify that on the 4th day of November, 1985, I surveyed the property shown on this plat, being known as lot 42 (1.22 acres) of plot of OAK HOLLOW SECTION 2 and recorded in the REC. Office Greenville County, S.C., in Plat Book # 7 - 2 at Page 51; and that the property lines, walls and buildings are as shown hereon, and that the walls and buildings located on said lot do not encroach or project on adjacent streets or property, and that no adjacent walls or buildings encroach or project on said premises, and no power lines cross this property except as shown hereon.

12-D-3 15713

R. S. Bruce

R. S. Bruce, RL 10288

CAROLINA SURVEYING CO.
112 Holly St.
Greenville, S.C.

Recordable Plat