

FILED
GREENVILLE CO. S.C.
JUN 20 3 02 PM '86
DUNNIE S. TANKERSLEY
R.M.C.

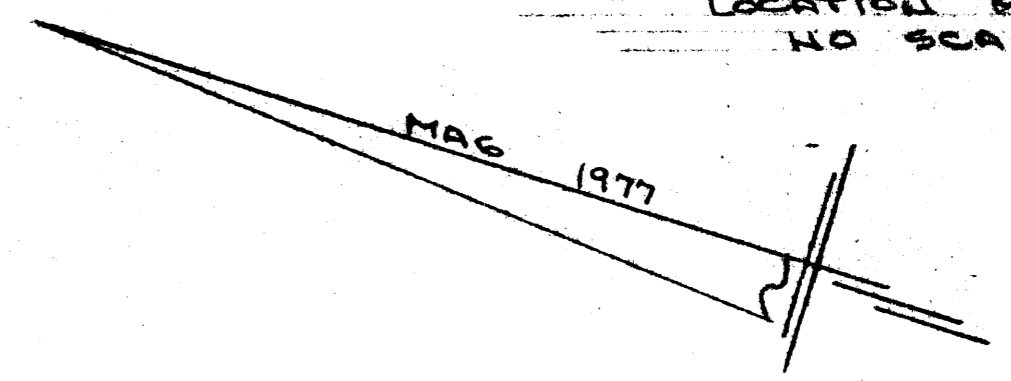

REF: DEED BOOK 1125 @ PAGE 331 & 332.
PLAT BOOK 0 @ PAGE 79. ALSO
PLAT OF LUCY B. G. ARMSTRONG
PROPERTY BY J. L. MONTGOMERY, III
DATED 10 MAY 1977, NOT RECORDED.

SURVEY FOR
BANK OF GREER
NEAR FORK SHOALS, GREENVILLE CO., S.C.
SCALE: 1"=100' 21 FEB 1986

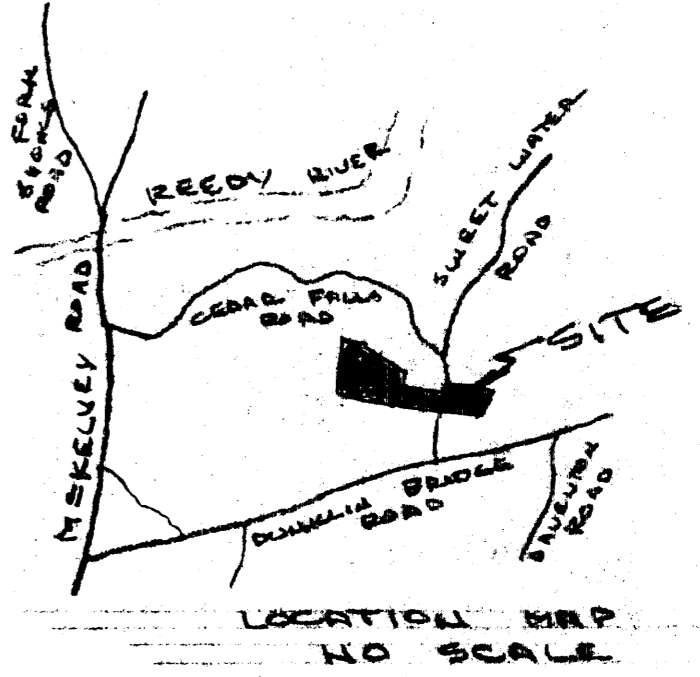
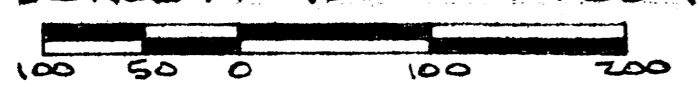

12-P-69
42947

I Certify that the Ratio of Precision of the Field Survey
is $1/5000'$ As Shown Herein And That the Area
Determined by D.M.D. Method of Area Calculations

R. B. Bruce
R. B. Bruce
R. B. BRUCE, RLS #1952

CAROLINA SURVEYING CO.
112 MAIN ST.
GREENVILLE, S.C.

12-P-70
42947
JUN 20 1986 398
JUN 20 1986 383