

LAKE HORSESHOE TRACT C

MICROFILMED

N04-11-06W 123.33'

U.G. UTIL.

EIP 2154'

170

FILED
GREENVILLE CC. S. C.
APR 22 - 1 08 PM '86
DUNNIE S. TANKERSLEY
R.M.C.

171

169

693.27 N 020-01-88 S

228.75' N 88-10-02 E

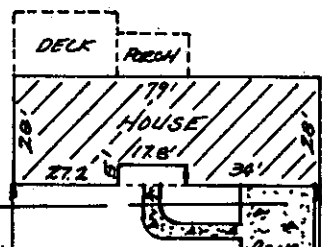
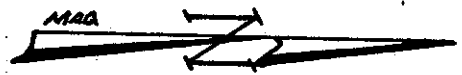

EIP

EIP 504.85' to BLACKHORSE RUN

S 01-49-58 E 123.22'

STEEPLECHASE COURT

PROPERTY OF
JERRY LEE HARRELL

12-Q-2

APR 22 1986

GRACE B. HARRELL

34658

GREENVILLE, GREENVILLE COUNTY S.C.

APRIL 16, 1986 SCALE 1"=50'

This is to certify that on April 16, 1986, I surveyed the property shown on this plat known as Lot No. 170 of Heritage Lakes Subdivision as recorded in the RMC Office for Greenville County in Plat Book 6-H at Page 15, and that the property lines, walls and buildings are as shown hereon, and that the building located on said lot does not project nor encroach on adjacent streets or property, and that no adjacent walls or buildings project nor encroach on said lot, and that no utility lines cross this lot except as may be shown hereon, or for service thereto. The degree of accuracy is 1:10,000.

NOTE: This property is not located within a flood hazard area.

Survey by: Richard B. Webster, Surveyor
Greenville, South Carolina

Richard B. Webster
S. C. R. L. 67-NO. 4698

3.0001 10' utility and drainage easement along side and rear lines.

RECORDABLE PLAT