

TRAC  
1954

FILED  
GREENVILLE CO. S. C.  
APR 28 2 06 PM '86  
DUNNIE S. TANKERSLEY  
R.M.C.

WATER MAIN WAY  
WATER & SEWER IN ST. B/W

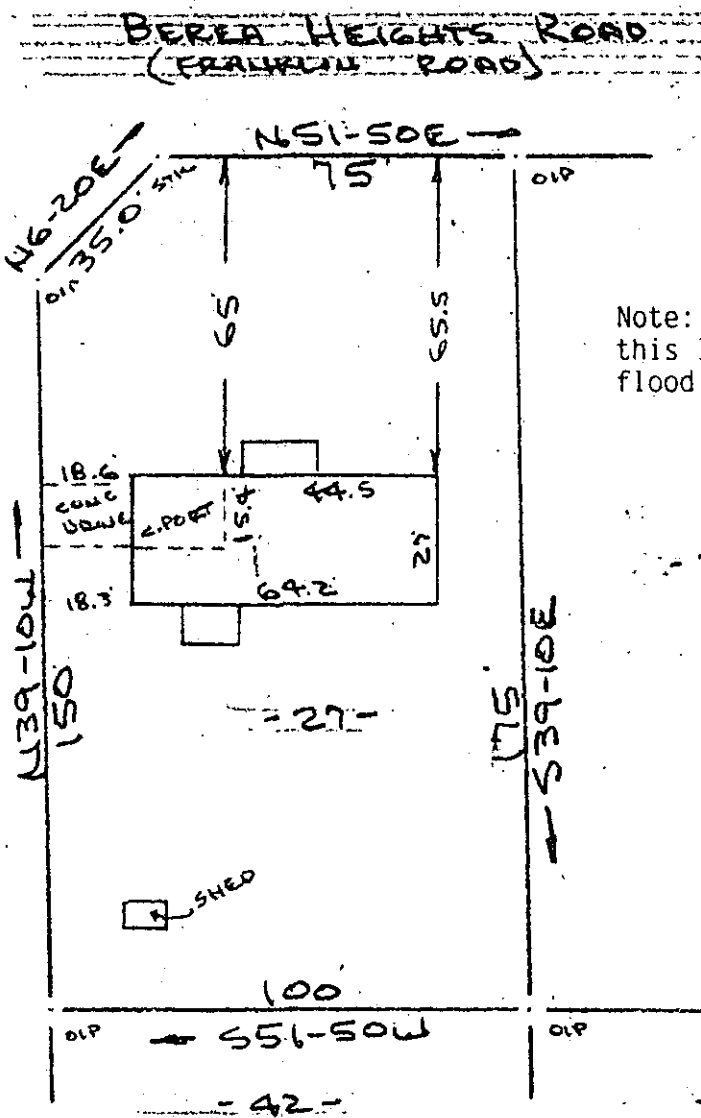

Note: Improvements on this lot are not in a flood hazard area.

- 28 -

PROPERTY OF

WALTER DANNY GILREATH & CINDY E. GILREATH

NEAR GREENVILLE, S.C.

SCALE: 1" = 40' 25 APR 1986

APR 28 1986  
12-A-41

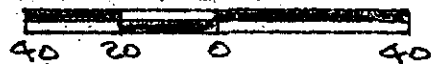

This is to certify that on the 25th day of April, 1986, I surveyed the property shown on this plat, being known as lot 27 on plat of BEREA HEIGHTS ADDITION and recorded in the RMC Office Greenville County, S. C., in Plat Book " EE " at Page 89 ; and that the property lines, walls and buildings are as shown hereon, and that the walls and buildings located on said lot do not encroach or project on adjacent street or property, and that no adjacent walls, or buildings encroach or project on said premises, no power lines cross this property and no visible encroachments except as shown hereon.

35305

R. B. Bruce

CAROLINA SURVEYING CO.  
112 Manly St.  
Greenville, S. C.

R. B. Bruce, RLS # 1952

Recordable Plat

300 8 31801