

NOTE:

DRAINAGE & UTILITY EASEMENT
ALONG ALL REAR & SIDE LOT
LINES. 5' EACH SIDE OF LINE.

10' DRAINAGE EASEMENT EACH
SIDE CENTERLINE OF EXIST.
NATURAL DITCHES.

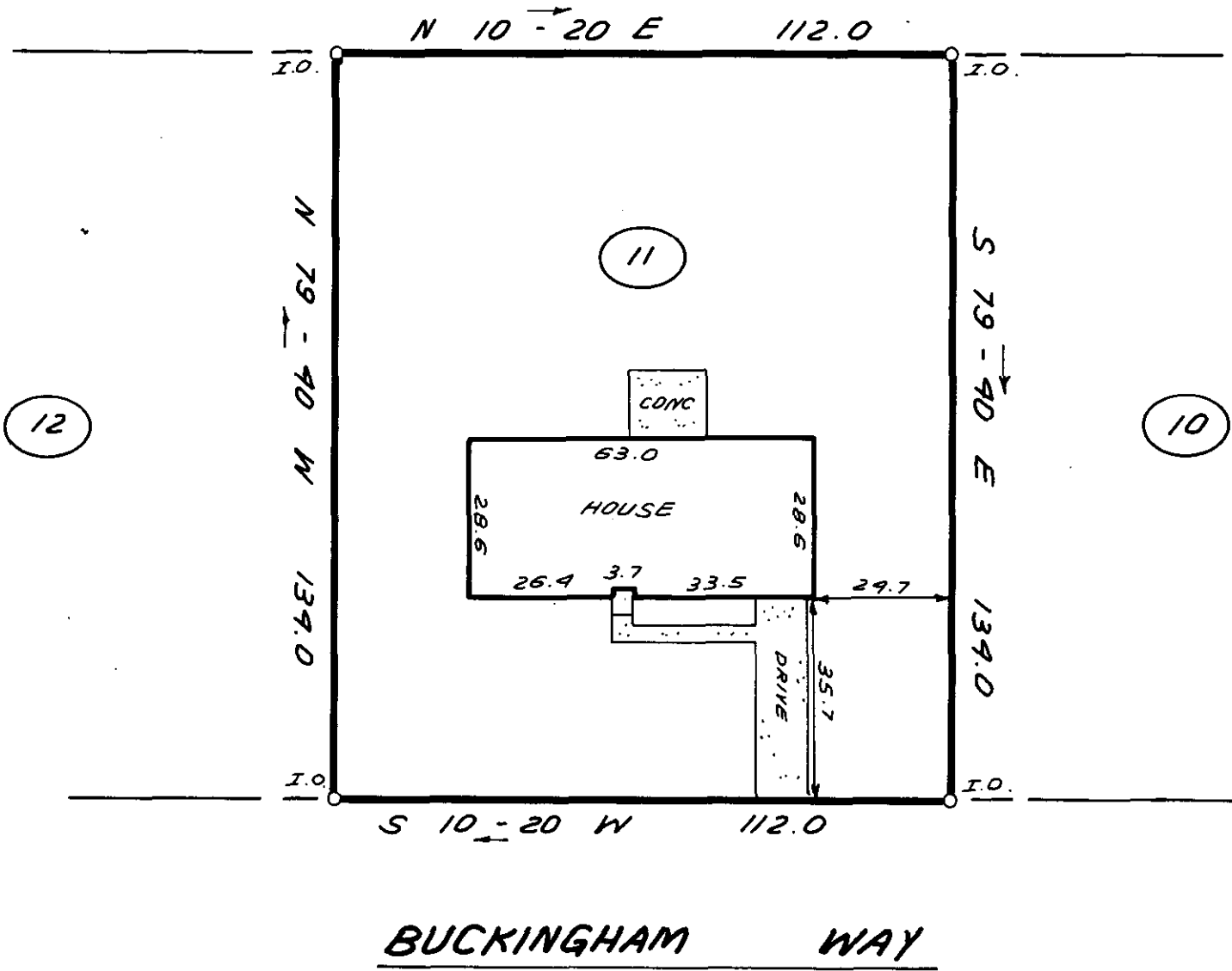

REF:

PLAT BOOK 7C-13
WINDSOR OAKS SUBDIVISION
SEC. 2, LOT 11
DEED BOOK 1114-895

SURVEY FOR
JESSE L. HARTLEY, JR.

GREENVILLE COUNTY
SOUTH CAROLINA
APRIL 28 1986

This is to certify that the property shown on this plat was surveyed under my direct supervision. Property lines and improvements shown are located correctly and that no visible encroachments exist unless otherwise shown. This property is not located in a designated flood hazard area.

SC10

I MY 30 86
560

FILED
GREENVILLE CO. S.C.
MAY 30 4 04 PM '86
DONNIE S. TANKERSLEY
R.M.C.

72-6-3

39910

SCALE: 1" = 30'



W. R. WILLIAMS, JR.
ENGR./SURVEYOR, Inc.
P. E. & L. S. No. 3979
15 S. MAIN STREET
TRAVELERS REST, S. C.
29690

7 33.1 - 2 - 11

"I hereby certify that the ratio of precision of the field survey is 1/5000 as shown hereon and the area was determined by D.M.D. method of area calculation."

W. R. Williams

P. E. & L. S. No. 3979