

State of South Carolina,  
Greenville County

At the request of Cal Washington I have surveyed his Home Tract of land, containing 58- $\frac{1}{2}$  acres, more or less, having such lines and boundaries as the above. Plat represents.

James P. Willis, Surv.

Recorded Nov. 6th, 1909.  
and Copied by J.B.---

-----

361

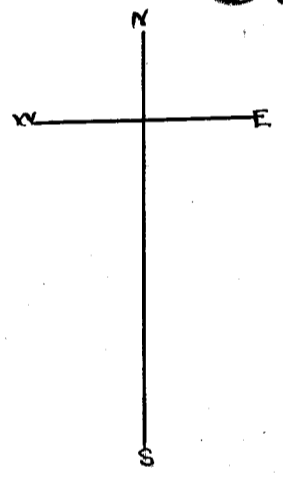
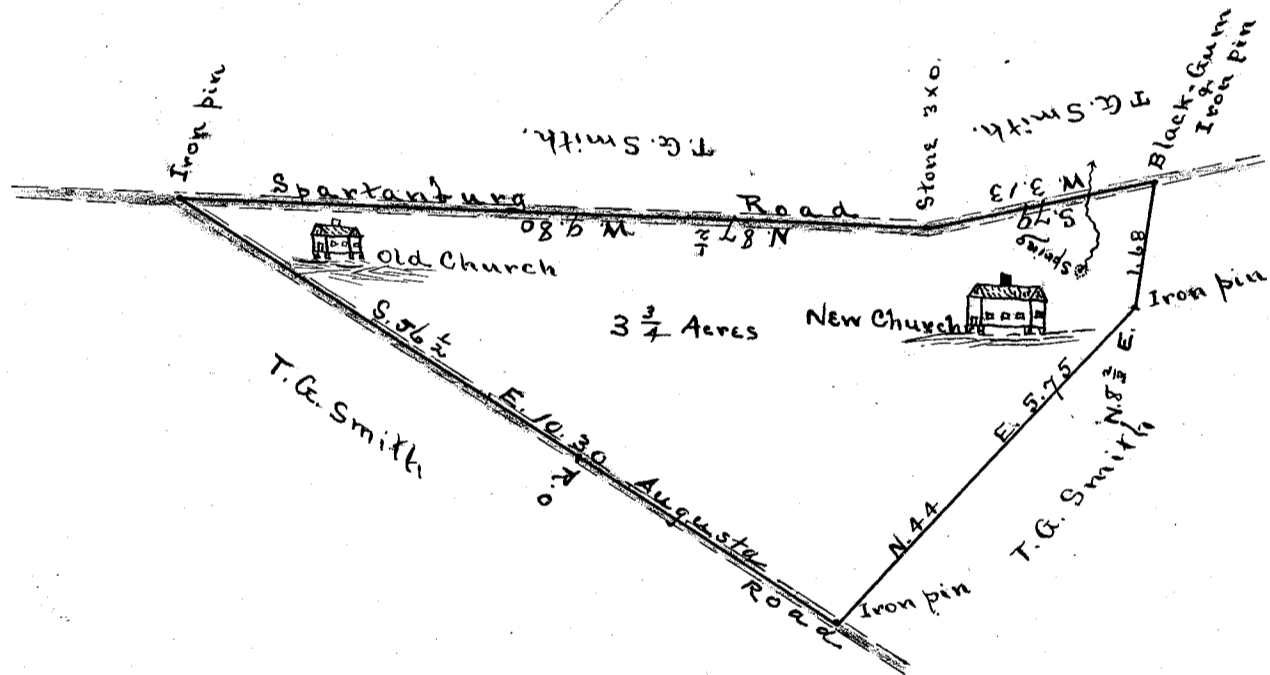

Scale at 2- $\frac{1}{2}$  Chains per inch.

State of South Carolina,  
County of Greenville.

By request of Green Clark, Baylis Hawkins, Henry Mayfield, Charlie Morris, Charlie Thompson Frank Anderson, Jack Green and Mc Todd, Deacons of the Enoree Fork Baptist Church and Thomas G. Smith, I have surveyed the above land, one lot  $\frac{3}{4}$  of one acre bought of G.W. Martin, One lot of one and one-half acres, and one and one fifth acres in one other lot, and  $\frac{30}{100}$  acres in the 3<sup>rd</sup> lot all bought of Thomas G. Smith and hath such shapes, marks and bounds as above stated. Surveyed Oct. 22nd, 1909.

W.A. Hudson, D.S.

Recorded November 15th, 1909

and copied by J.B. --