

South Carolina } The above plat by B. H. Arves
 Greenville County } shows 238 Acre land, sold by J. C. Hamner to W. A.
 Henderson Dec 2nd 1909 copy by W. A. Hudson

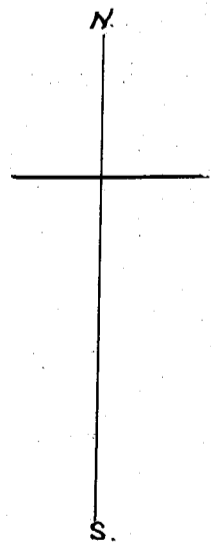
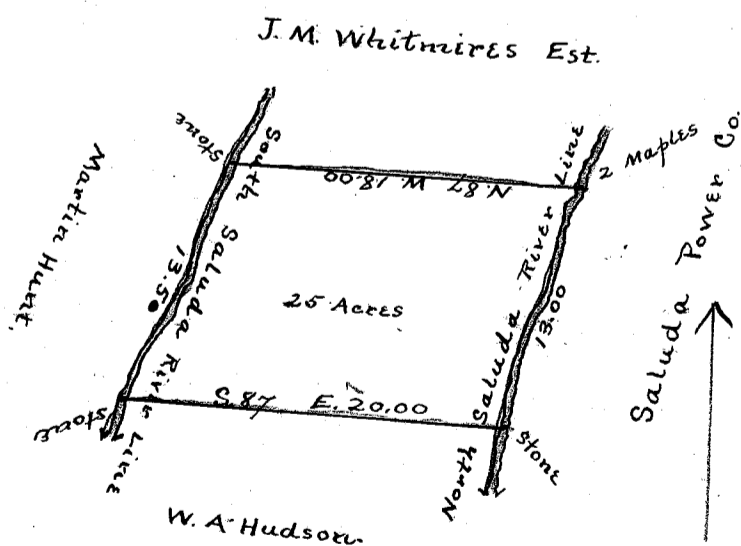
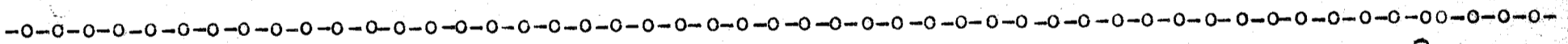

Scale 10 chs. to an inch.

See Plat Book E
Page 31

South Carolina,
Greenville County.

The above plat describes twenty-five (25) acres of land sold by W. A. Hudson to John H. Williams, both of said County and State aforesaid, between North Saluda River and South Saluda River centre of each stream, and hath such marks, and bounds as above stated, said tract being part of the Laura Norwood Land, sold her by Hamlin Beattie and Avery Patton and by her to W. A. Hudson. Surveyed Oct. 8th., 1909.

Wm. A. Hudson, D.S.

Recorded April 20th, 1910.
and copied by J.B.